

# EASY MONITOR ALIGNMENT KIT

## INSTRUCTION MANUAL

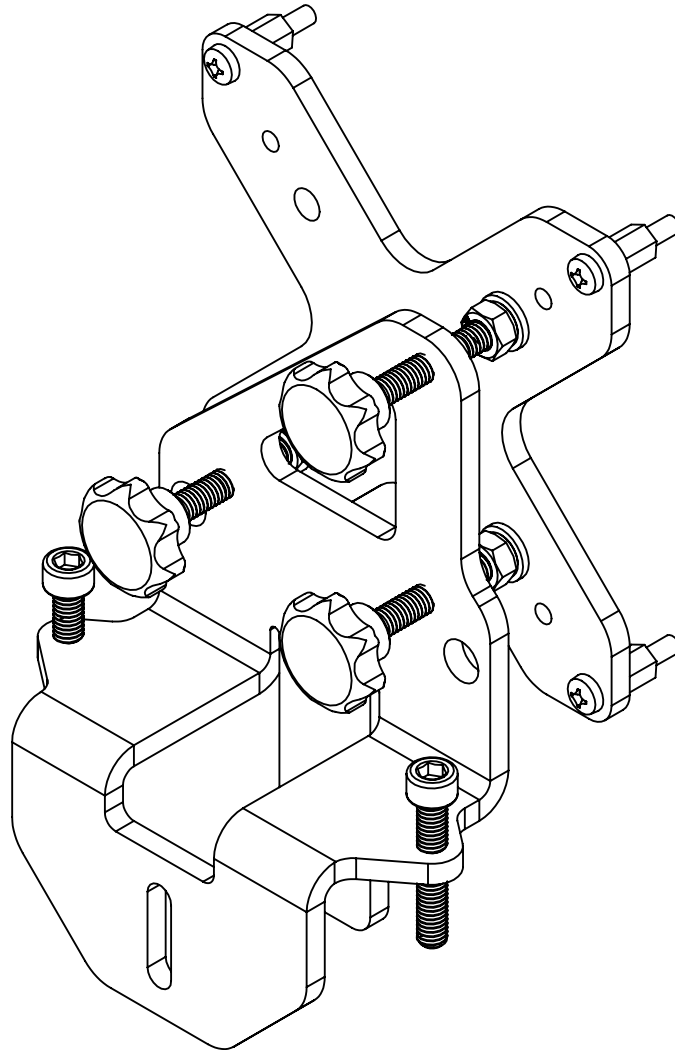

### REQUIRED TOOLS:

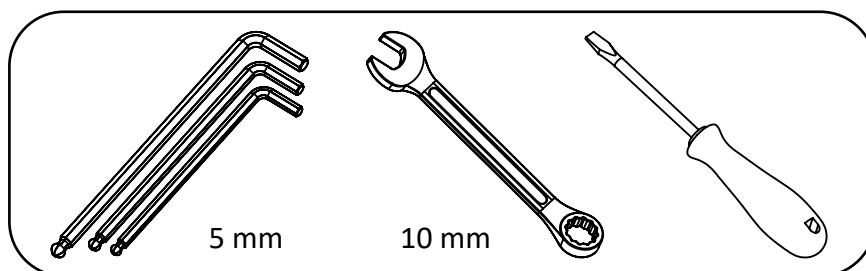

# INCLUDED ITEMS

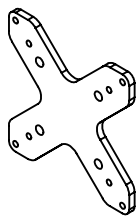

VESA Bracket  
**1x**

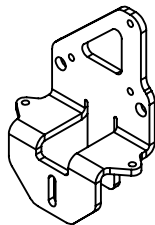

Adjustment Bracket  
**1x**

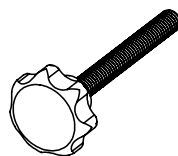

M6x50 Knob  
**3x**

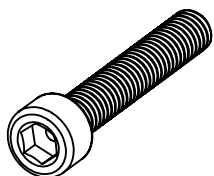

Nylon M6x35  
**2x**

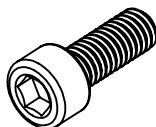

M6x16  
**1x**



M6 T-Nut  
**1x**



M6 Lock Nut  
**6x**



M4x12  
**4x**

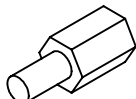

M4 Spacer  
**4x**



M6 Washer  
**1x**

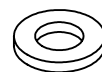

Nylon Washer  
**6x**

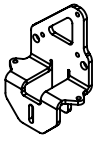

Adjustment Bracket

1x

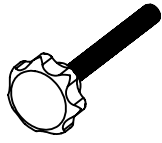

M6x50 Knob

3x

1

Mount the M6 knobs into the adjustment bracket.

Make sure you turn the knobs far enough into the brackets (they should stick out at least 21mm).

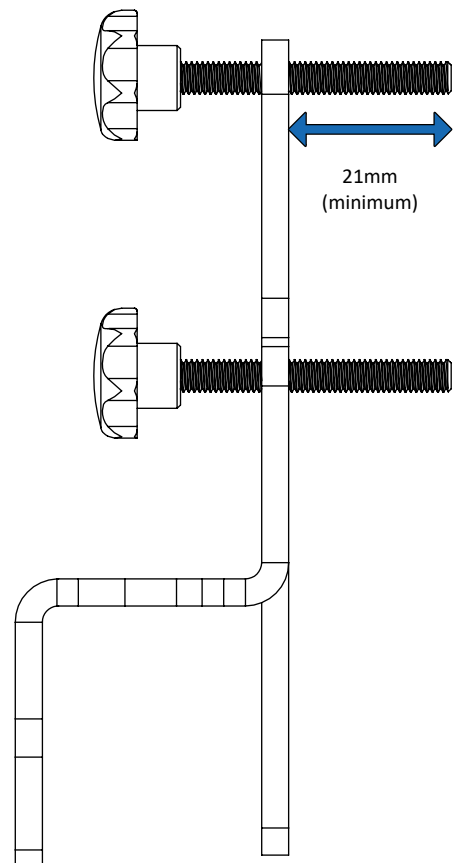
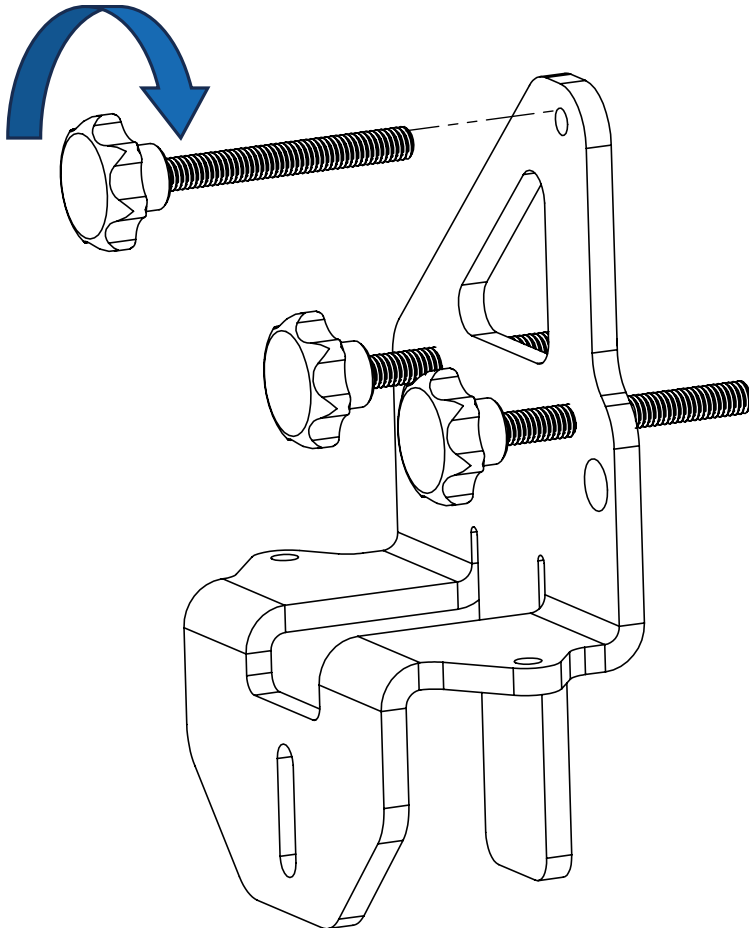



M6 Lock Nut  
3x

2

Mount 3 of the M6 lock nuts onto the thread of the knobs. The distance from the head of the nut to end of the thread should be around 14mm. This can be fine-tuned in step 5.

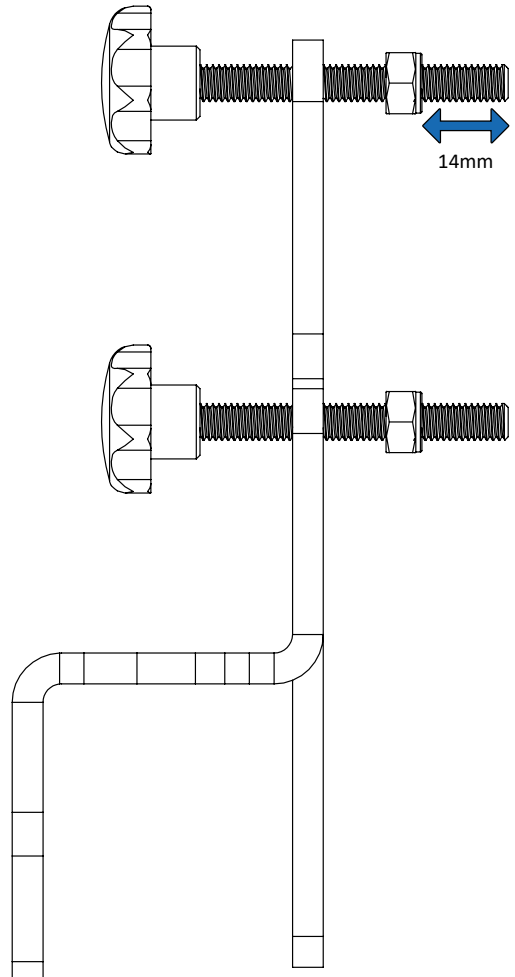
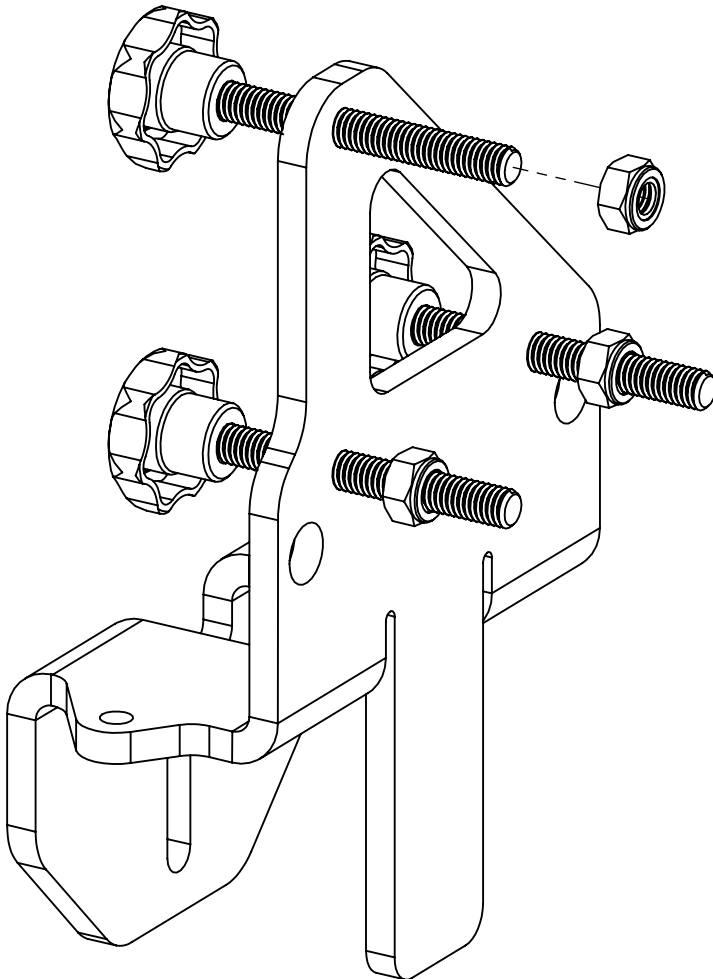

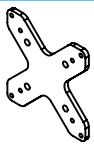

VESA Bracket

1x

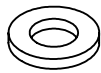

Nylon Washer

6x

3

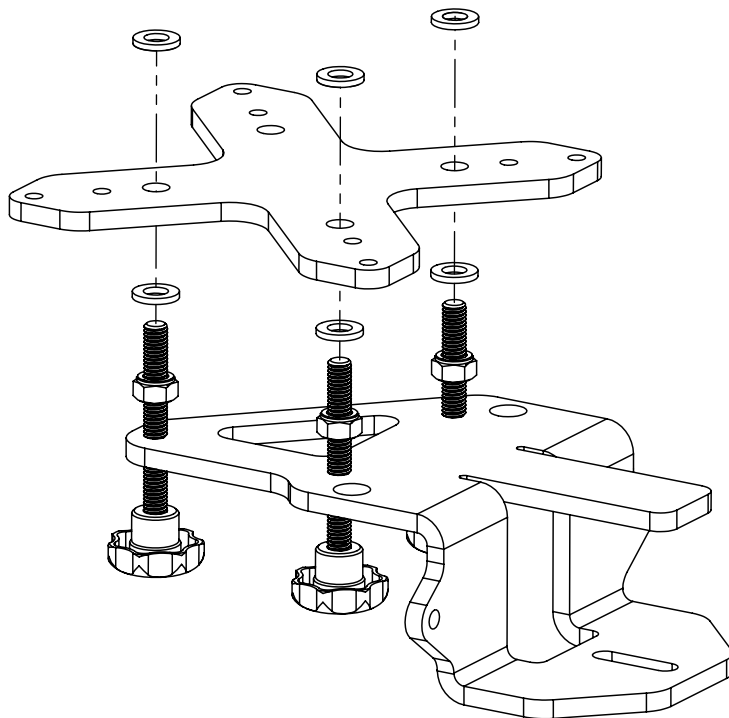

M6 Lock Nut

3x

4

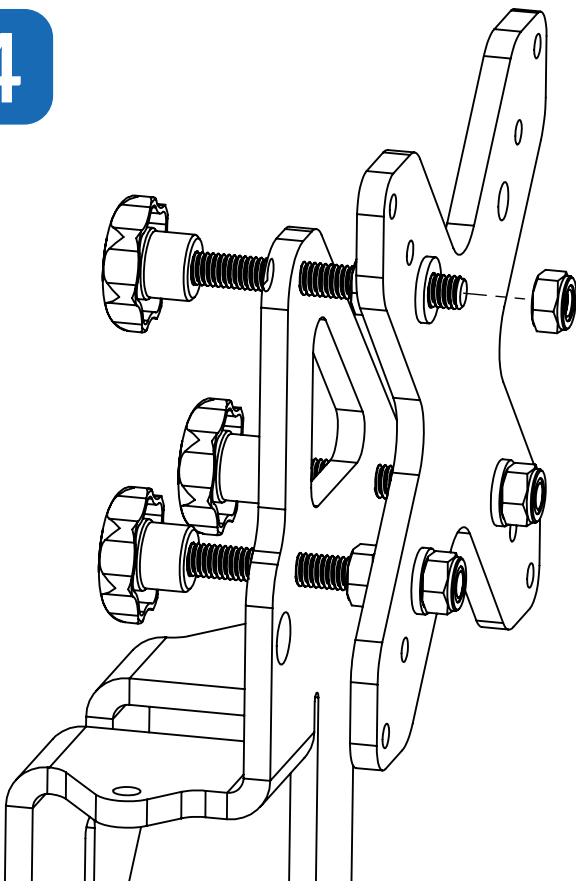

Make sure the M6x50 thread goes all the way through! This way the lock nut can actually 'lock' itself.

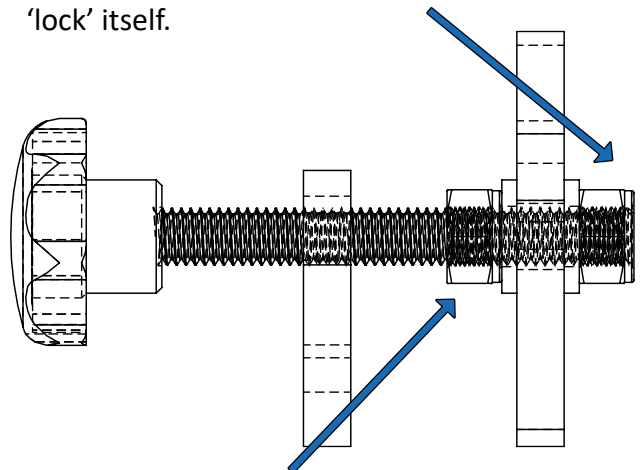

Turn this M6 nut to line up all the nuts, washers and the VESA bracket to the end of the M6x50 thread. **But do not tighten it! As soon as you feel the resistance increase, stop rotating.** The VESA bracket must have a tiny amount of freedom, and must not be clamped.

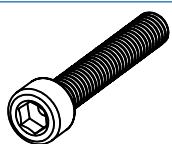

Nylon M6x35  
2x

5

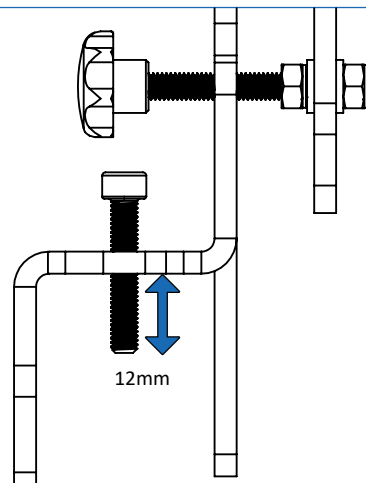
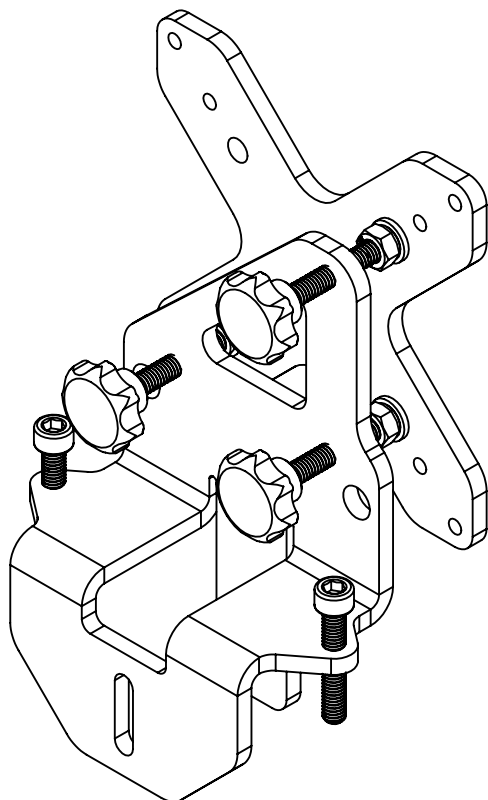

Mount the M6x35 bolts into the assembly. You can let them stick out around 12mm, but this can be adjusted later when you are fine tuning the alignment of your monitors.

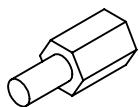

M4 Spacer  
4x

6

Mount the M4 spacers into the back of your monitor's VESA mount.

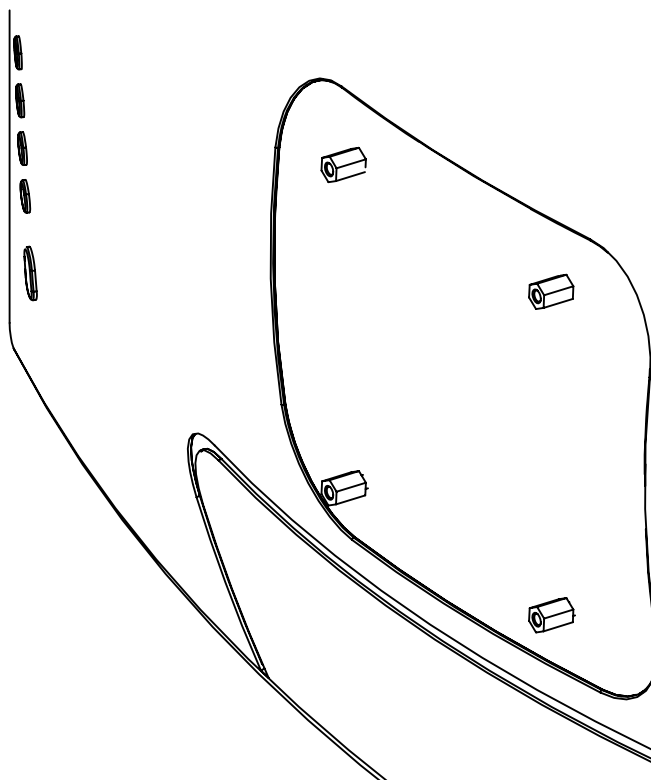



M4x12  
4x

7

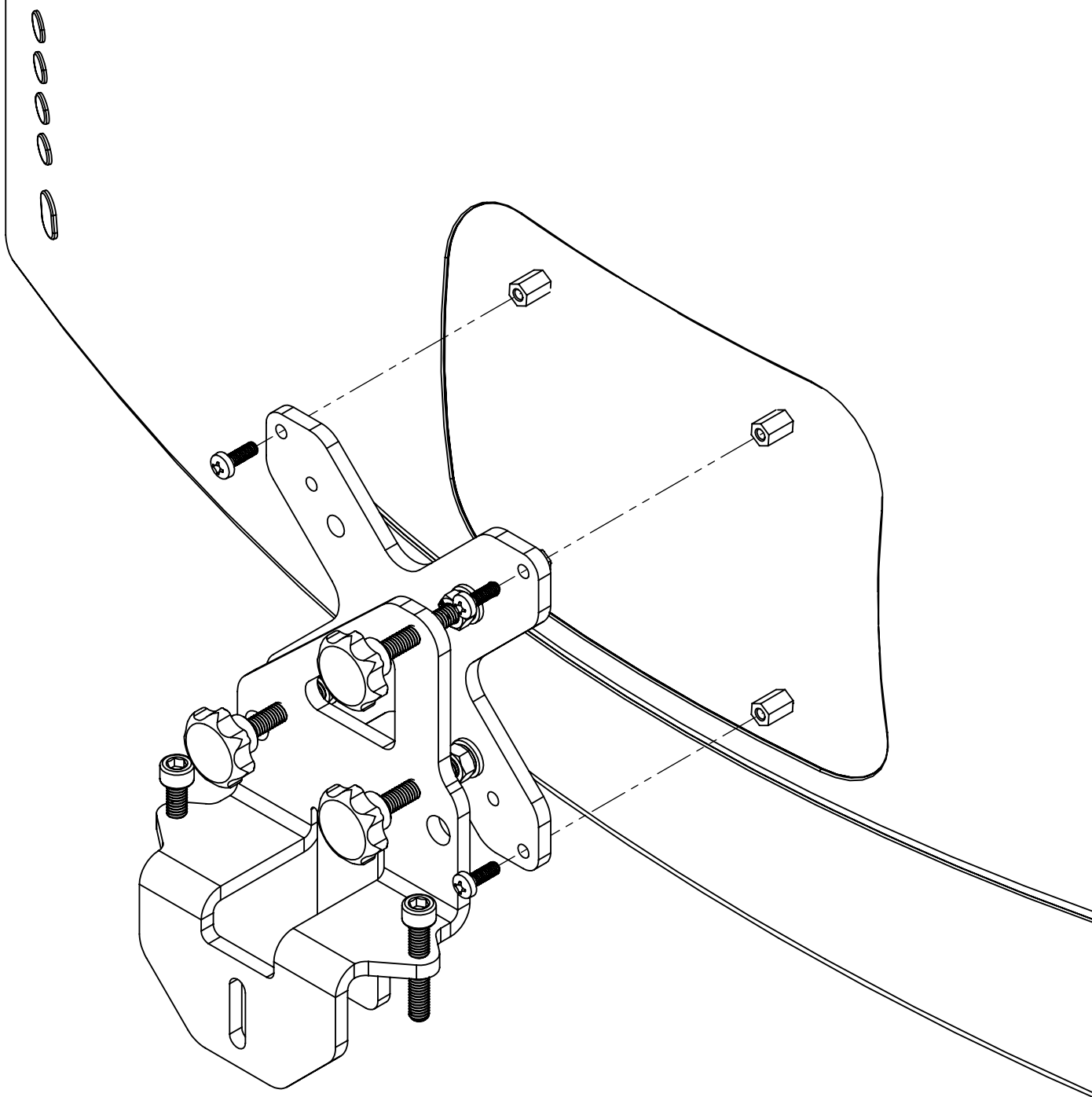

8

Place your screen on top of the desired profile.

Adjust the horizontal position by slightly lifting your monitor and by sliding the assembly along the profile.

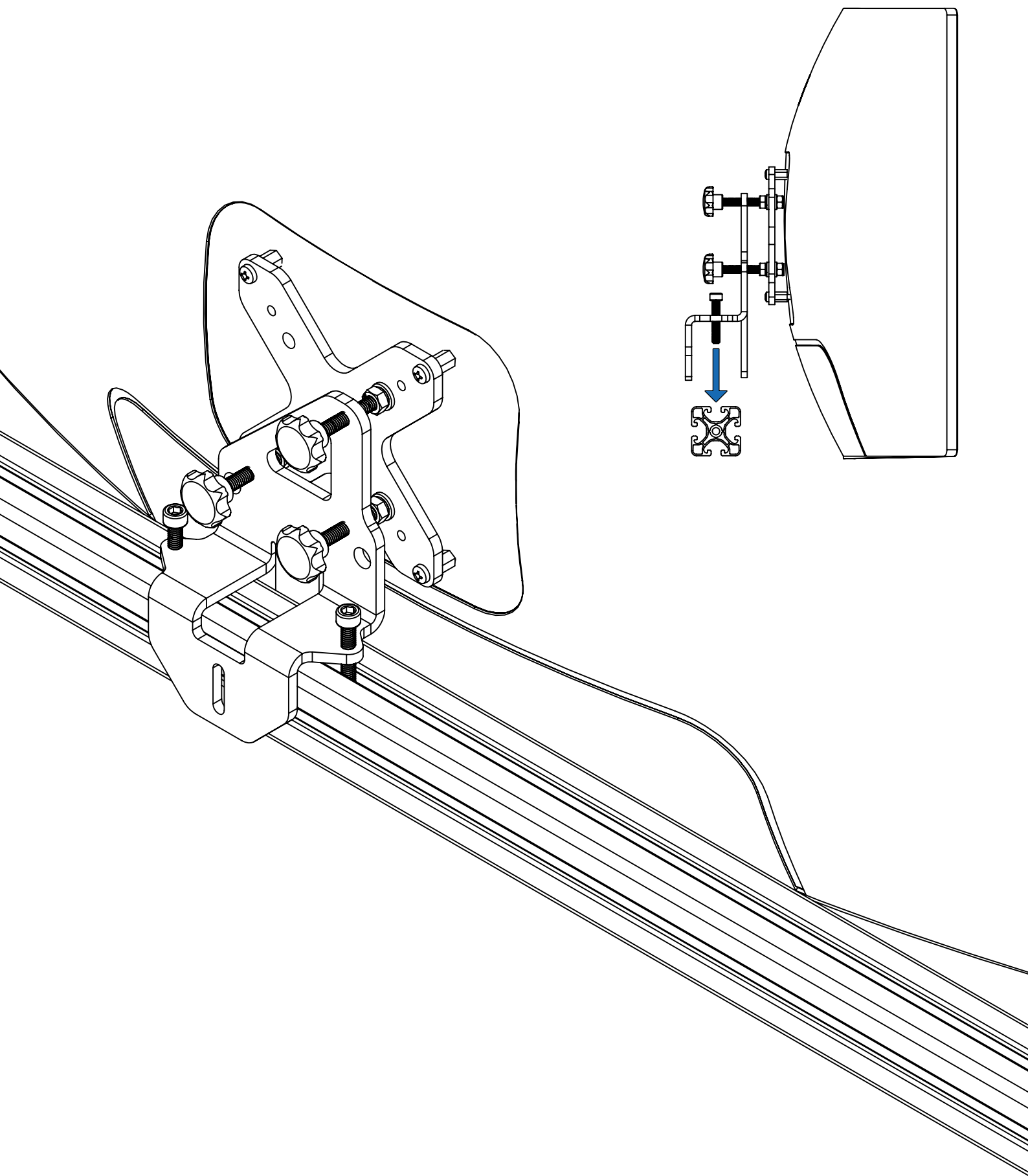



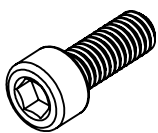

M6x16  
1x



M6 T-Nut  
1x



M6 Washer  
1x

9

This step is **optional**.

If you wish to secure your monitor, use the M6x16 bolt to do so. Please note that tightening this bolt might influence the alignment.

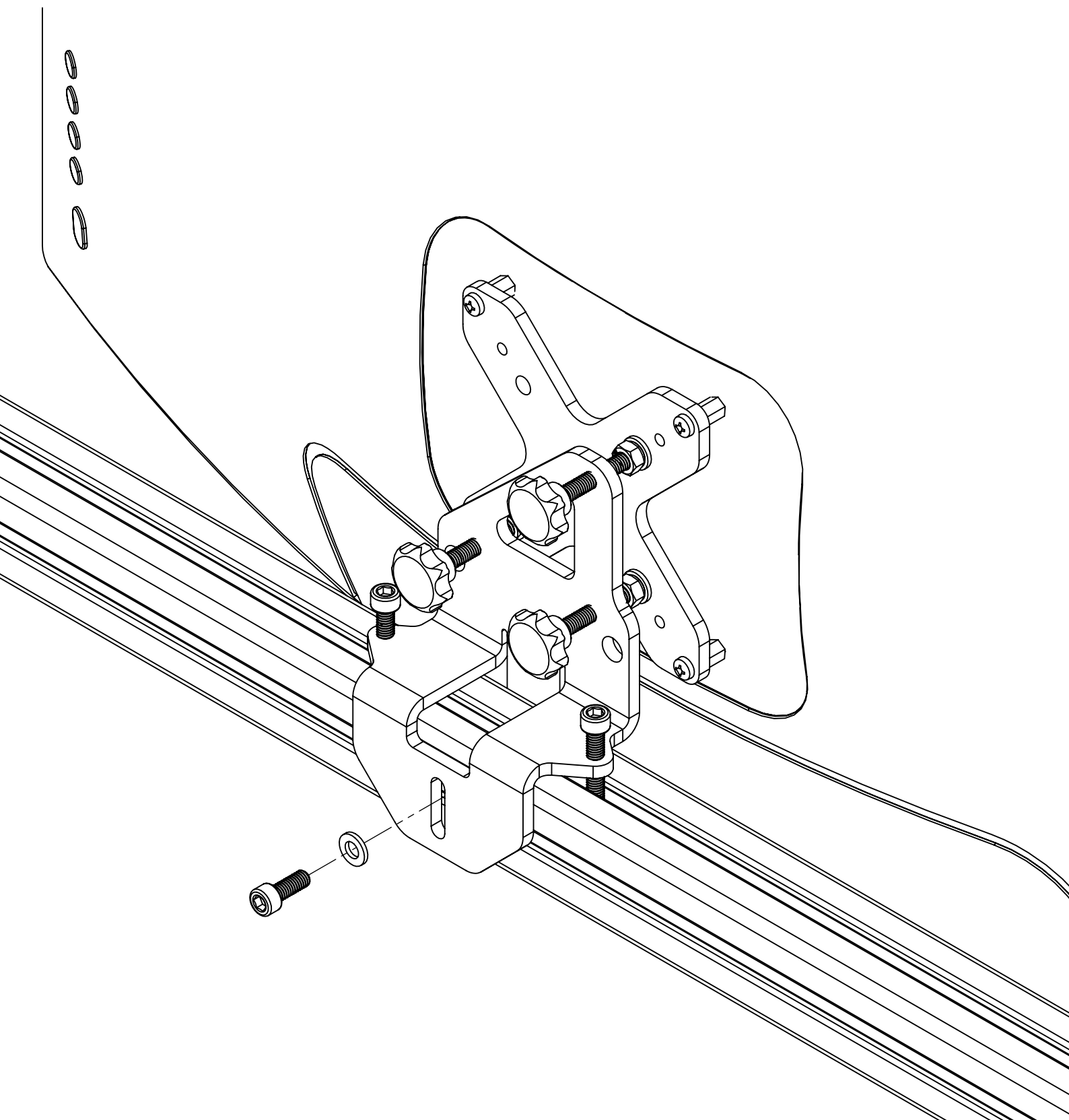

10

Fine tune the position of your monitor.

