

# SINGLE MONITOR STAND 4040

## INSTRUCTION MANUAL

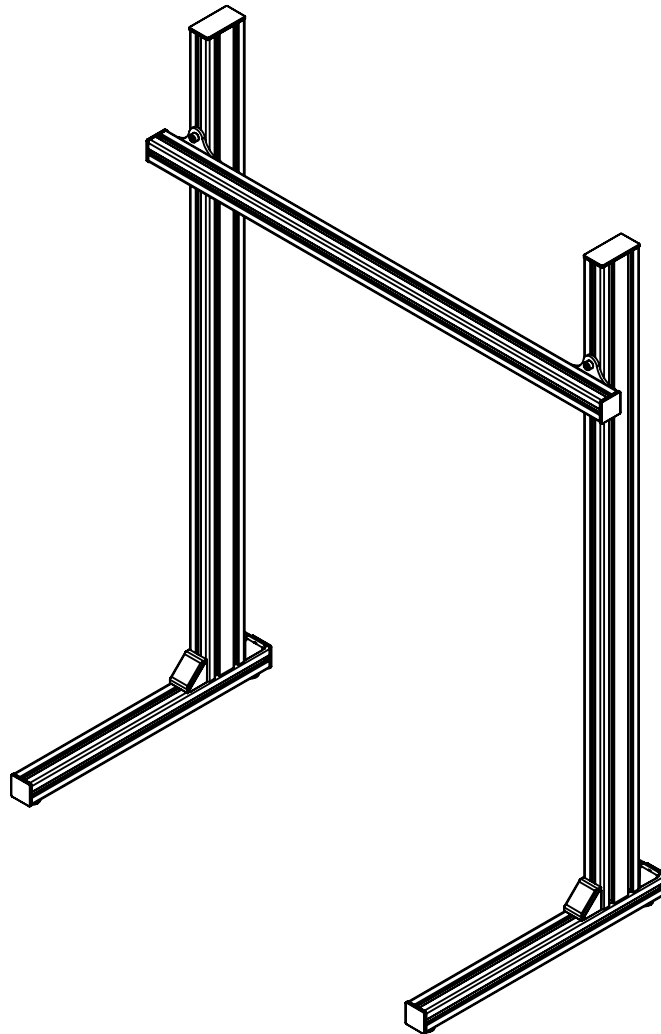

### REQUIRED TOOLS:

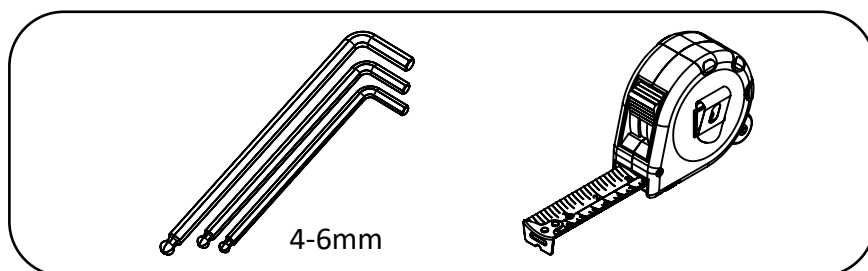

# GENERAL INSTRUCTIONS

The easiest way to mount the T-Slot Click-in-Nuts, is to slide them in from one side of the profile, with the ball facing down. But don't worry if you need to put in a click-in-nut in a profile which has both ends already closed: it is also possible to push them in the T-slot anywhere you like!

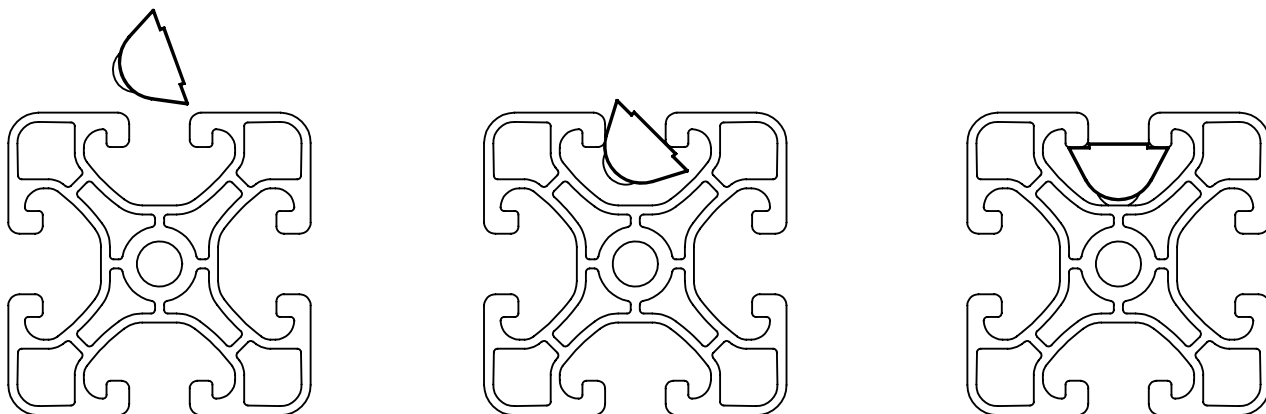

## INCLUDED ITEMS

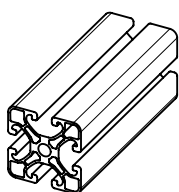

4040 L=500  
2x

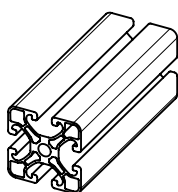

4040 L=950  
1x

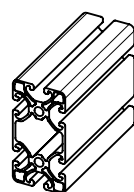

8040 L=1170  
2x

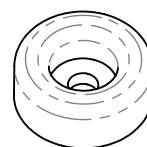

Rubber Foot  
4x

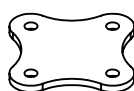

Perpendicular Plate  
2x

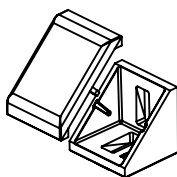

Corner Bracket  
4x

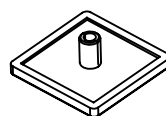

Cover 4040  
6x

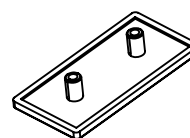

Cover 8040  
2x

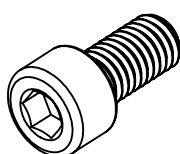

M8x16  
8x

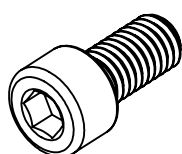

M8x16 (Black)  
8x



M5x12  
4x



M8 T-Nut  
16x



M5 T-Nut  
4x

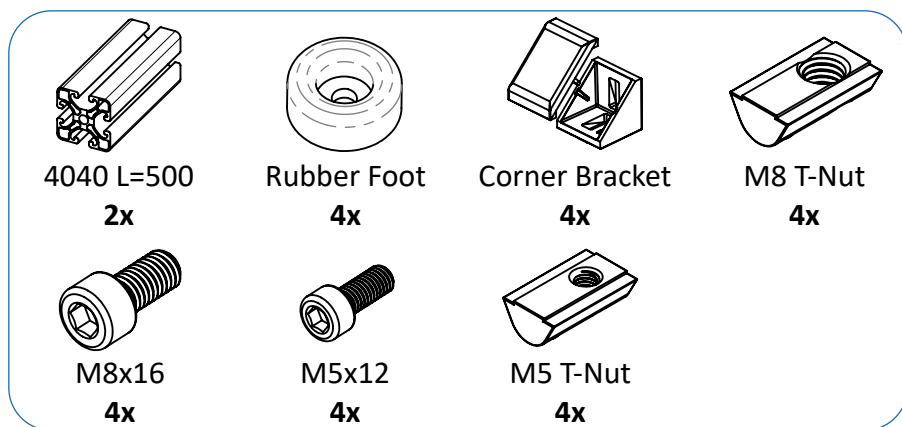

**1**

Attach the rubber feet and the corner brackets to the 4040 L=500 profiles. Perform this step twice.

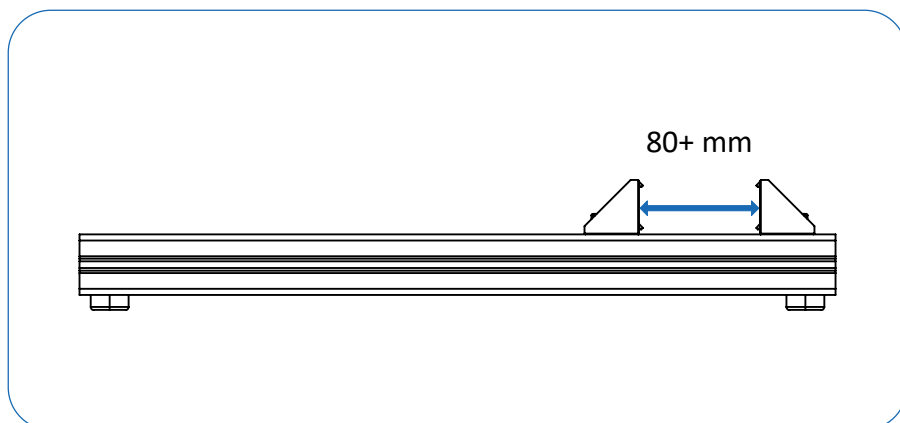
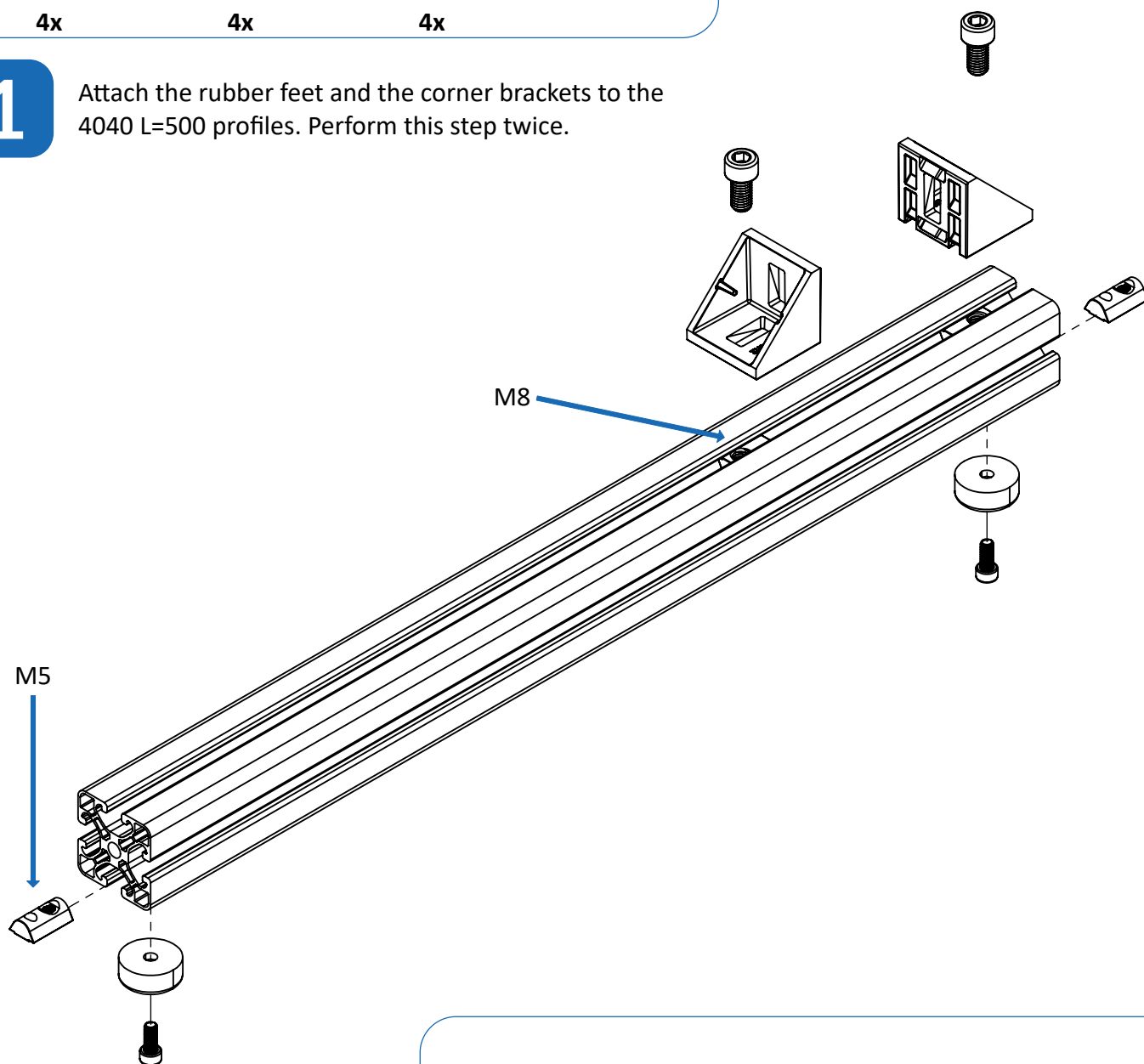

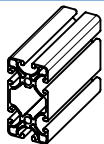

8040 L=1170

2x



M8x16

4x



M8 T-Nut

4x

2

Mount the 8040 profiles.  
Perform this step twice.

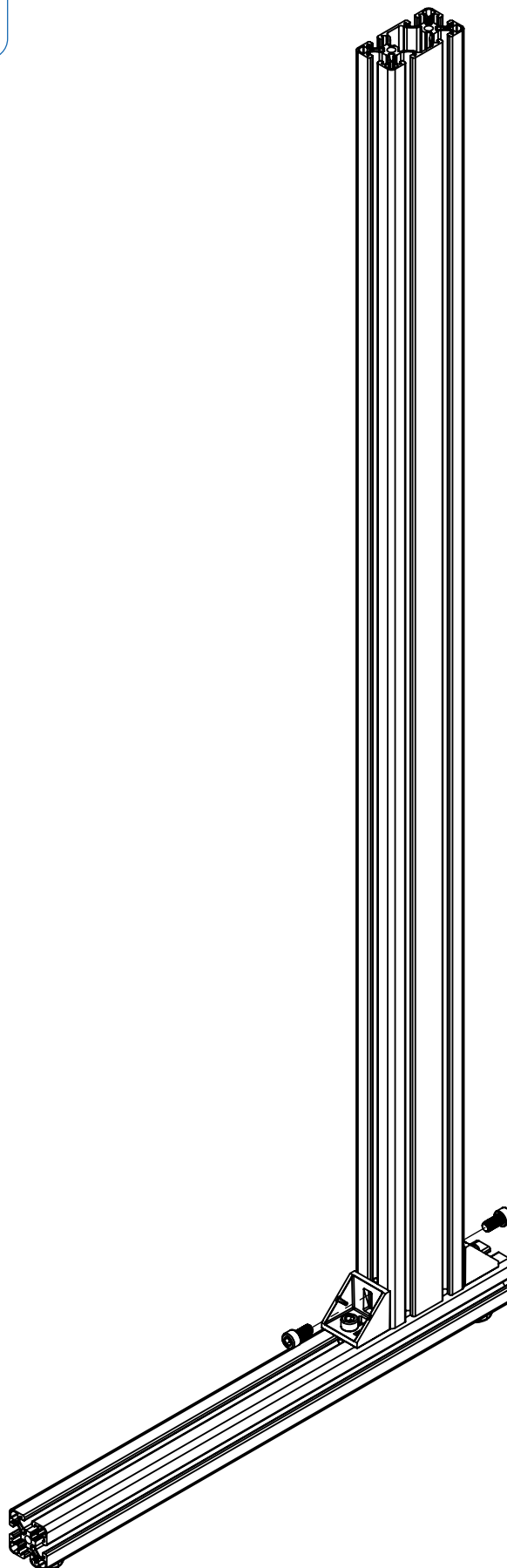

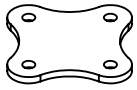

Perpendicular Plate  
**2x**

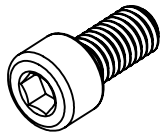

M8x16 (Black)  
**4x**



M8 T-Nut  
**4x**

**3**

Perform this step twice.

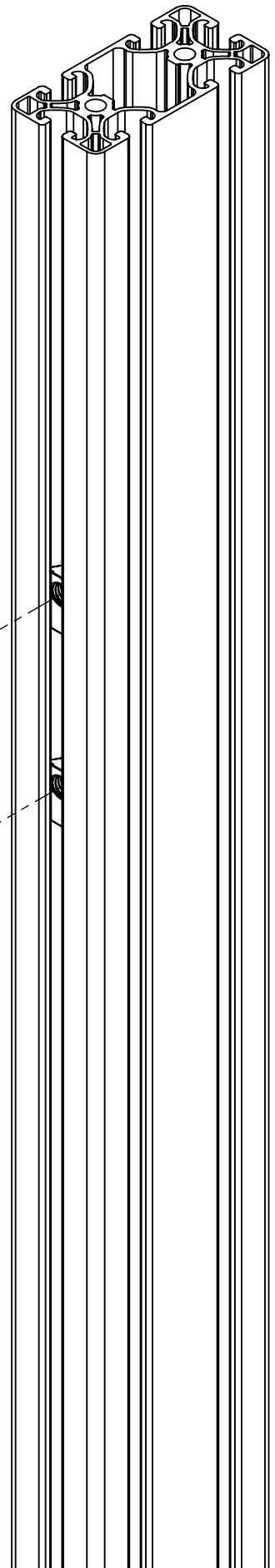
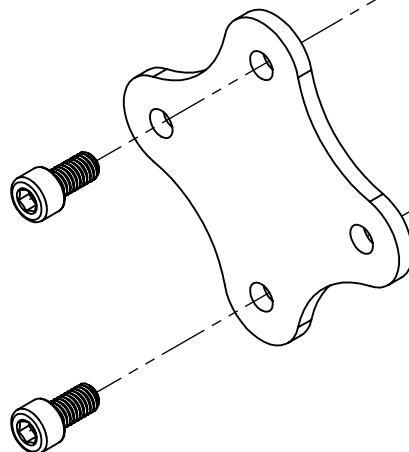
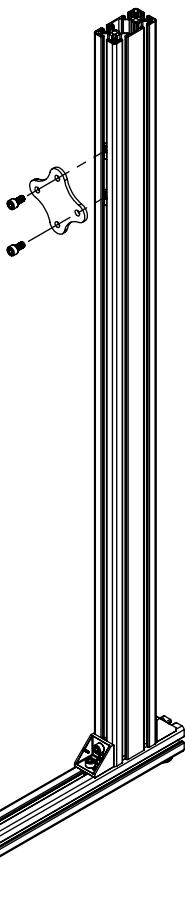

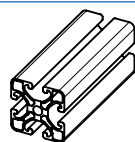

4040 L=950

1x

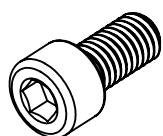

M8x16 (Black)

4x



M8 T-Nut

4x

4

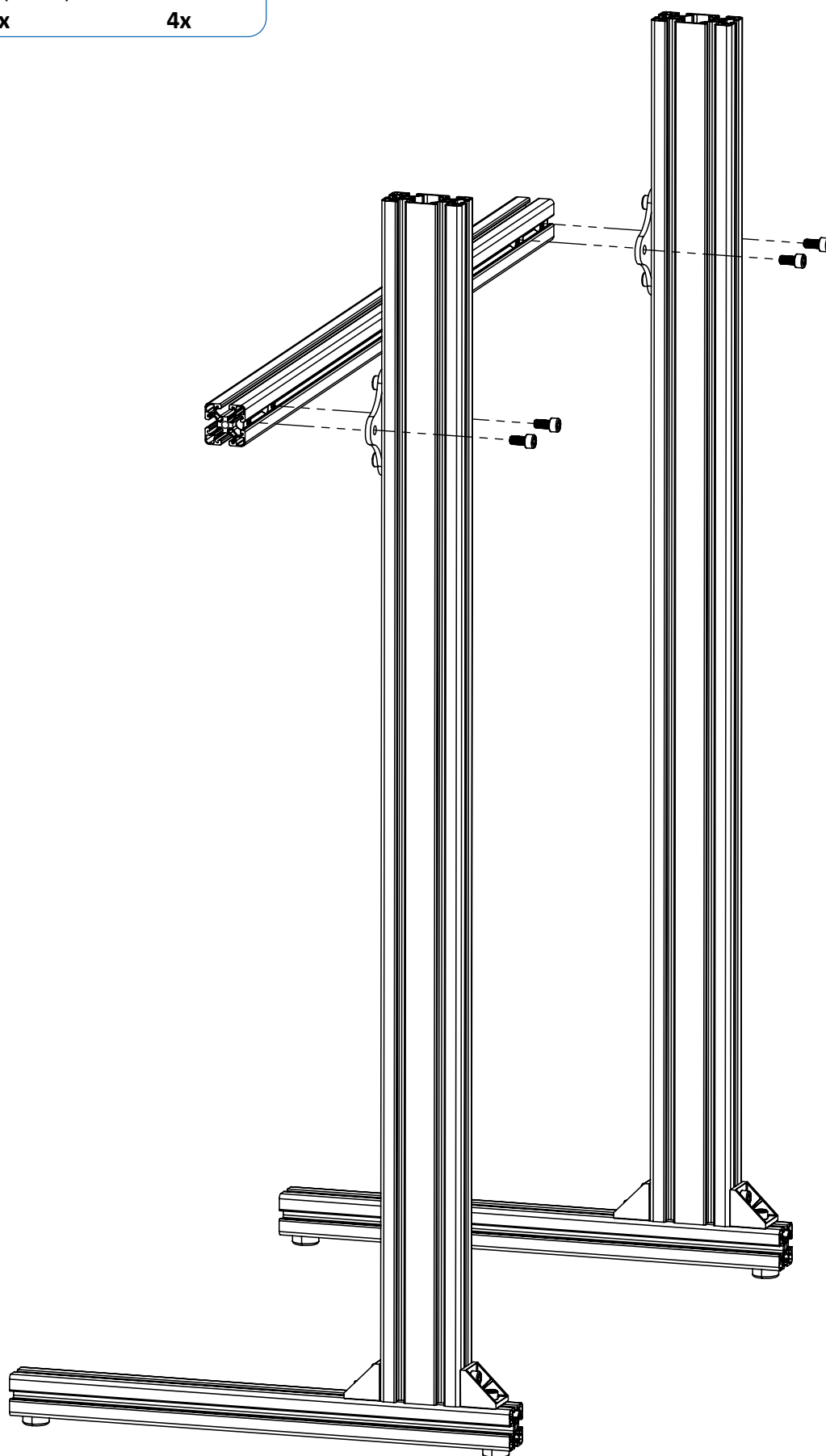

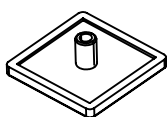

Cover 4040  
6x

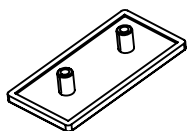

Cover 8040  
2x

5

Place all cover caps on the end of the profiles.

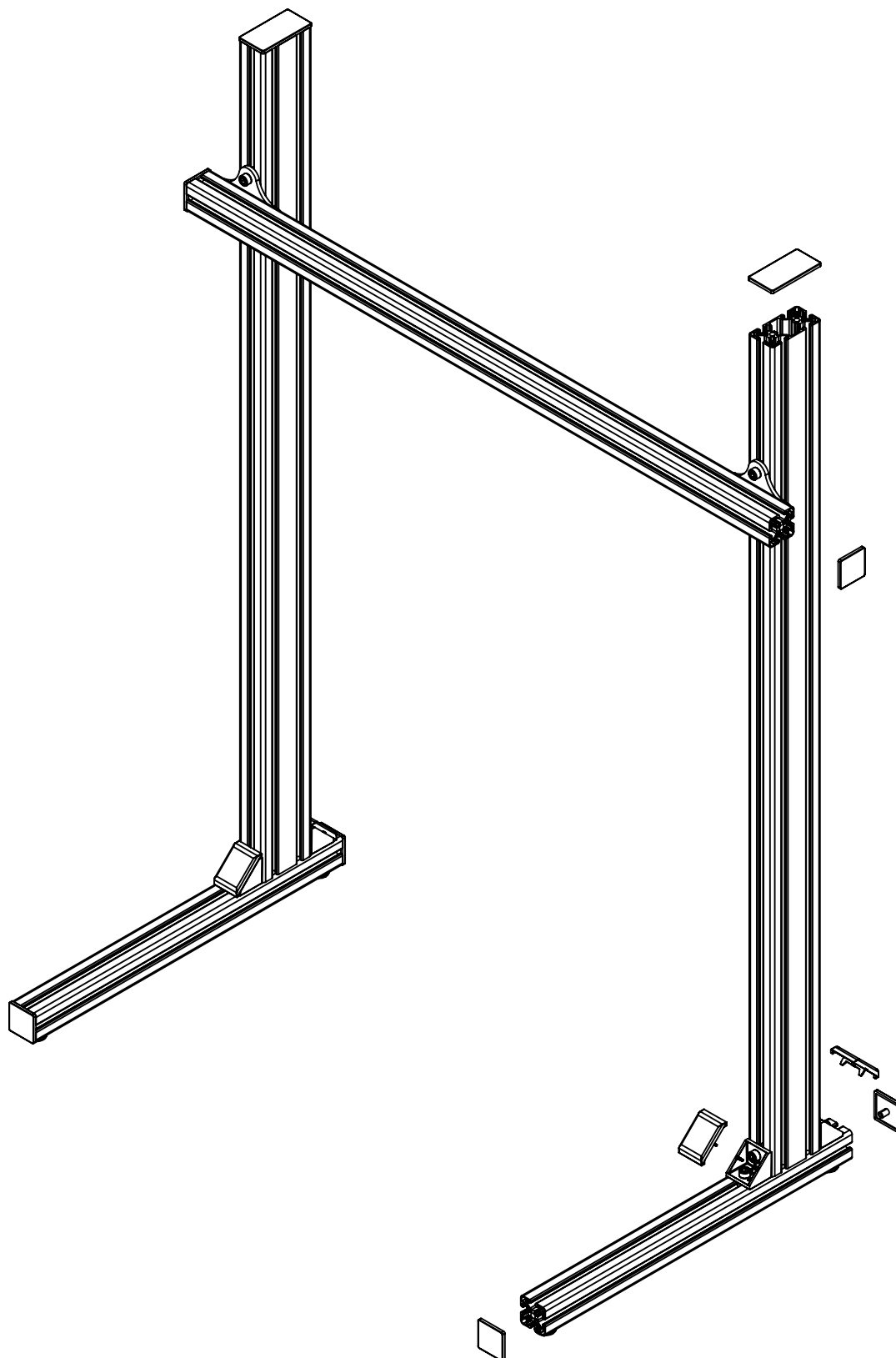

6

This monitor stand had the option of 'Standard VESA Bracket' and 'Easy Monitor Alignment Kit'. Both these monitor mounting solutions have their own manual. Please proceed the build of your monitor stand by using one of these. Find them at <https://www.treq-sim.com/manuals>

## EASY MONITOR ALIGNMENT KIT

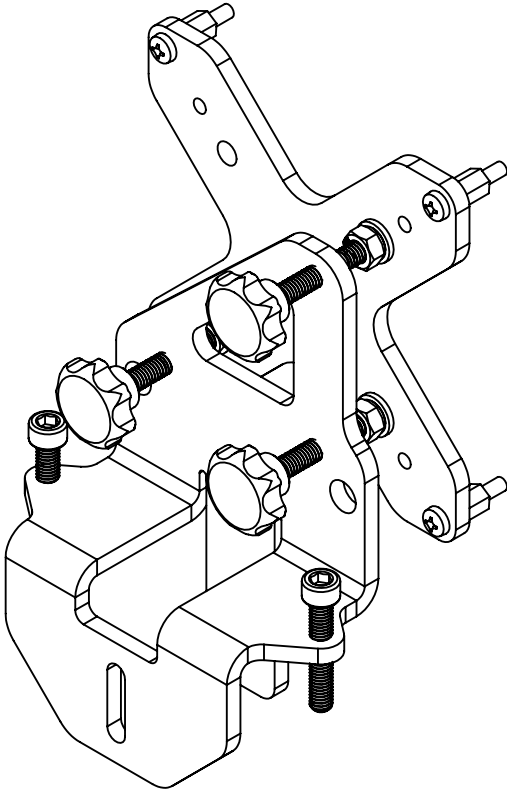

## STANDARD VESA BRACKET

