

# TRIPLE MONITOR STAND 8040

## INSTRUCTION MANUAL

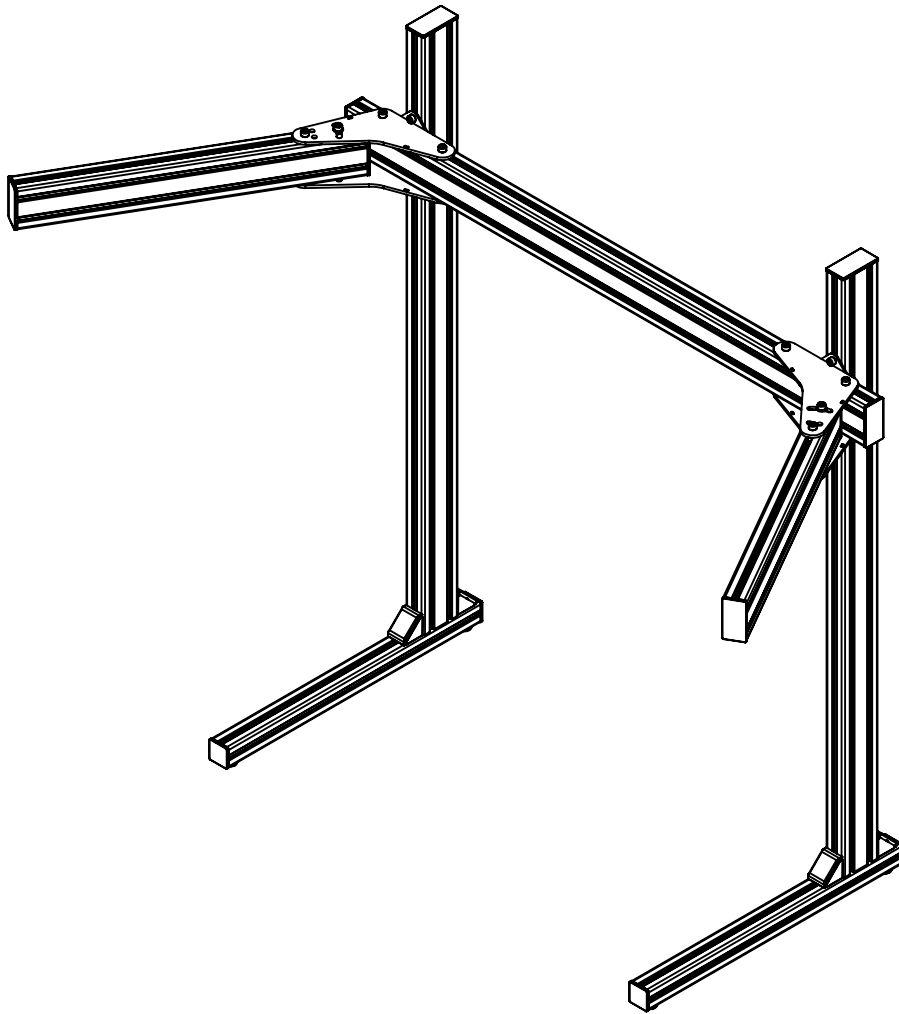

### REQUIRED TOOLS:

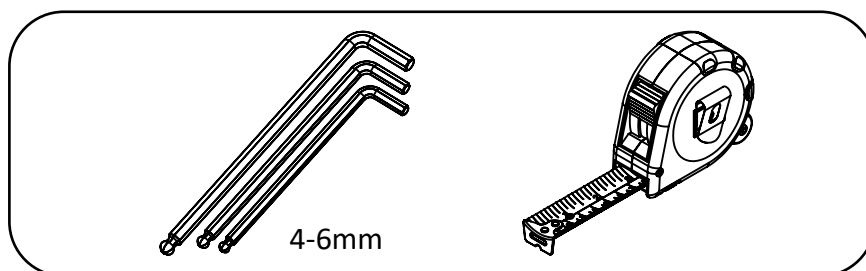

# GENERAL INSTRUCTIONS

The easiest way to mount the T-Slot Click-in-Nuts, is to slide them in from one side of the profile, with the ball facing down. But don't worry if you need to put in a click-in-nut in a profile which has both ends already closed: it is also possible to push them in the T-slot anywhere you like!

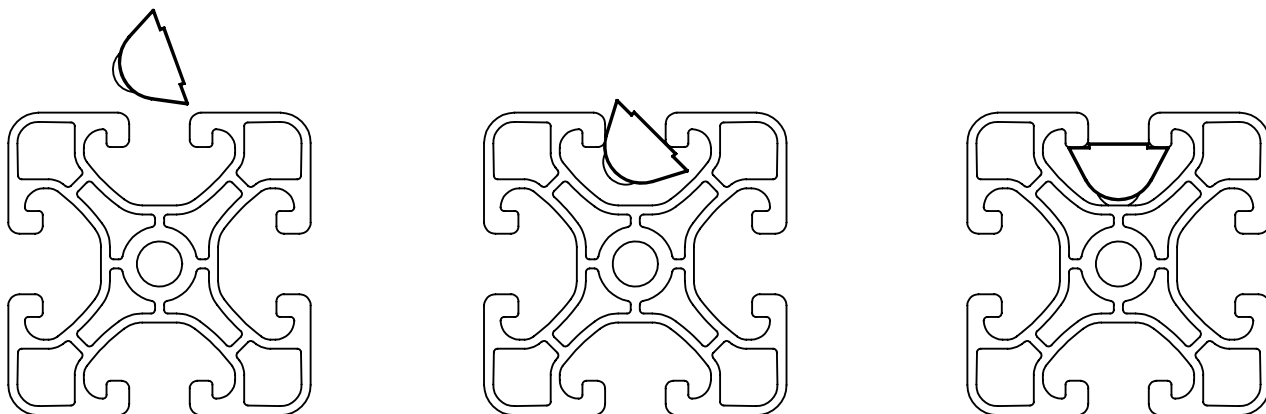

## INCLUDED ITEMS

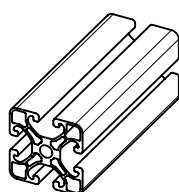

4040 L=570

2x

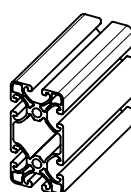

8040 L=580

2x

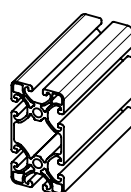

8040 L=1170

3x

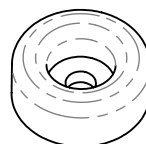

Rubber Foot

4x

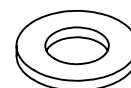

M8 Washer

4x

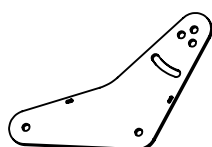

Connector Plate

4x

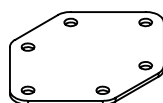

Perpendicular Plate

2x

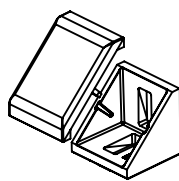

Corner Bracket

4x

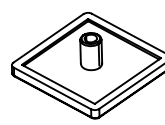

Cover 4040

4x

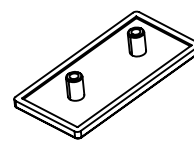

Cover 8040

8x

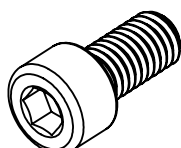

M8x16

8x

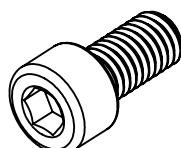

M8x16 (Black)

16x



M8x12 (Black)

12x

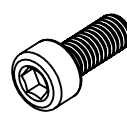

M5x12

4x



M8 T-Nut

36x

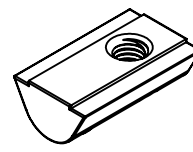

M5 T-Nut

4x

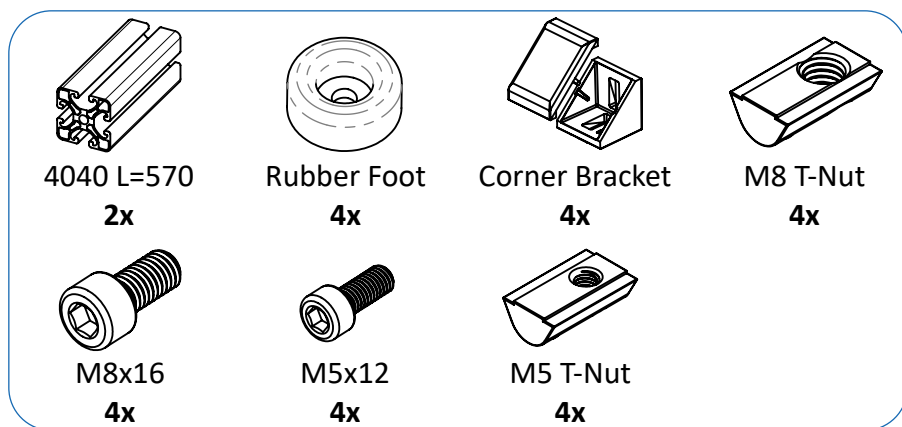

1

Attach the rubber feet and the corner brackets to the 4040 L=570 profiles. Perform this step twice.

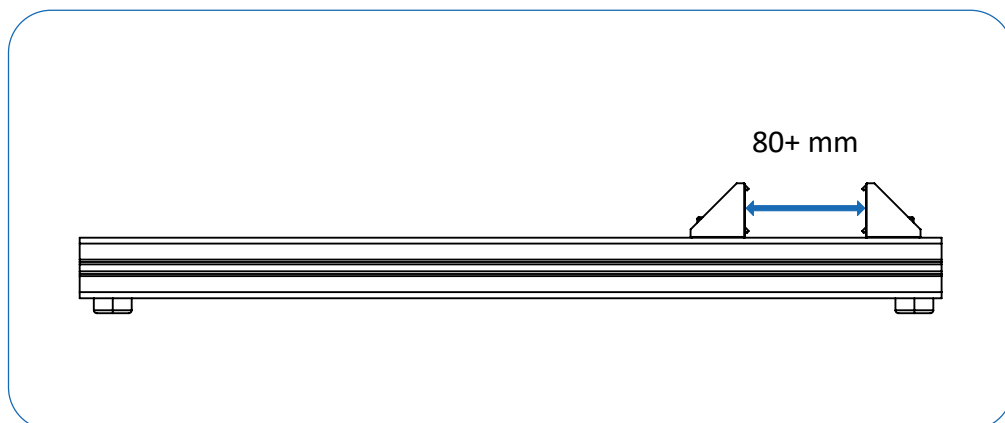
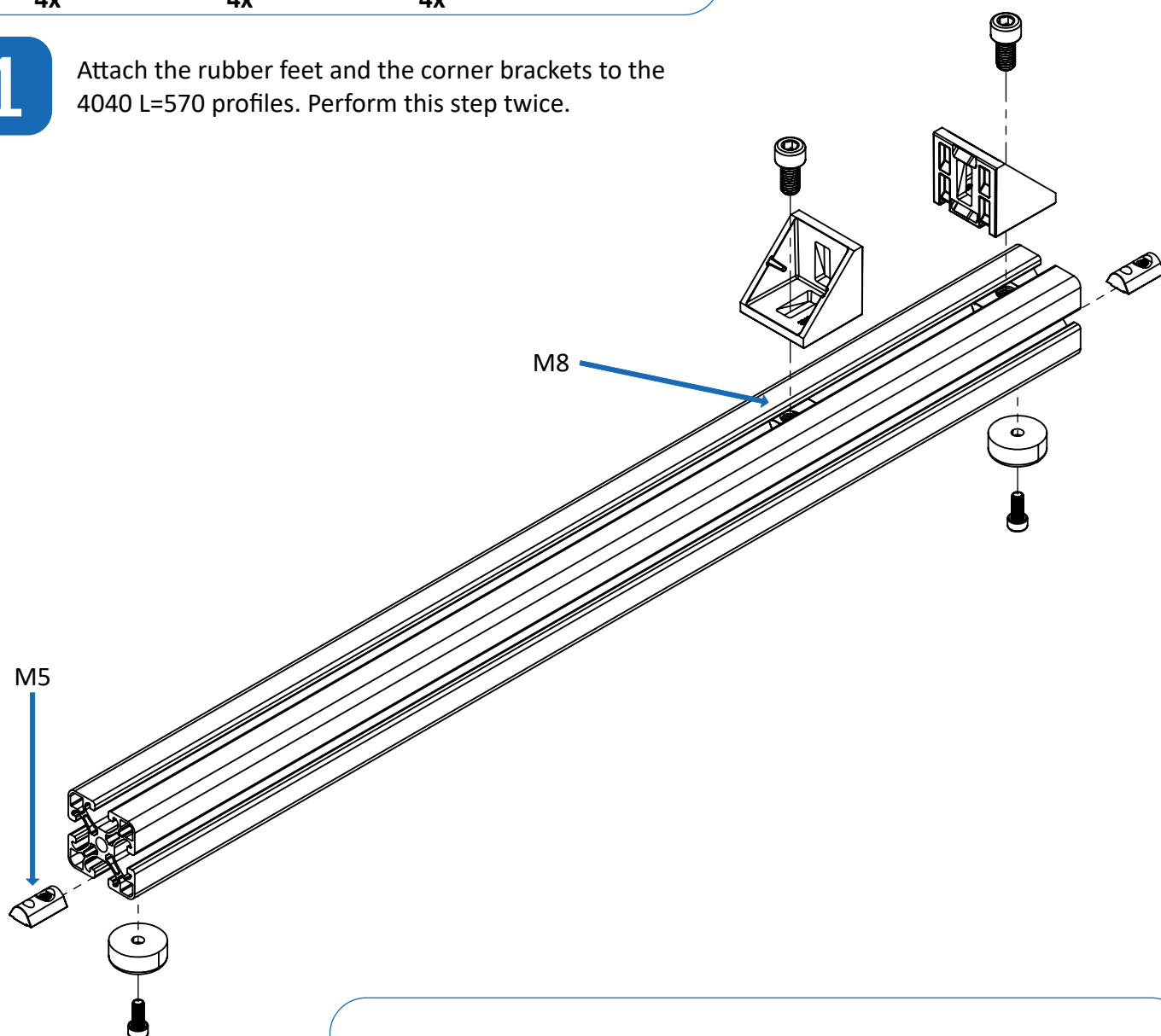

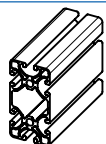

8040 L=1170

2x



M8x16

4x



M8 T-Nut

4x

2

Mount the 8040 profiles.  
Perform this step twice.

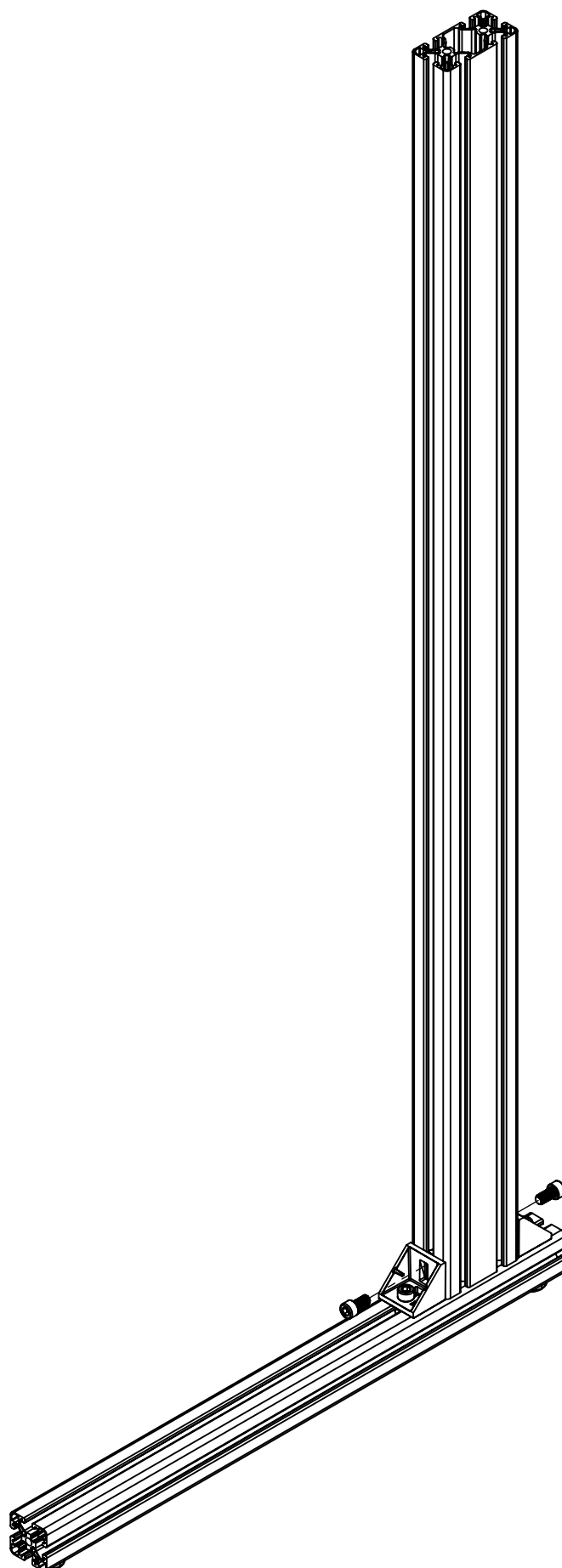

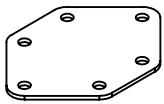

Perpendicular Plate  
**2x**

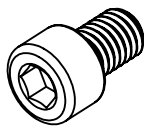

M8x12 (Black)  
**4x**



M8 T-Nut  
**4x**

**3**

Perform this step twice.

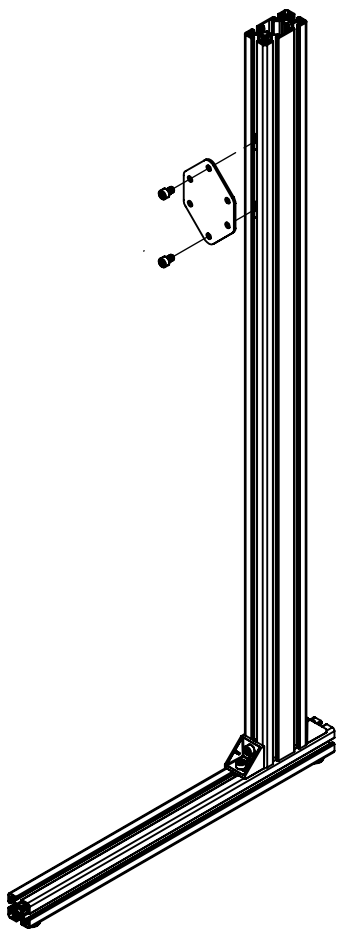
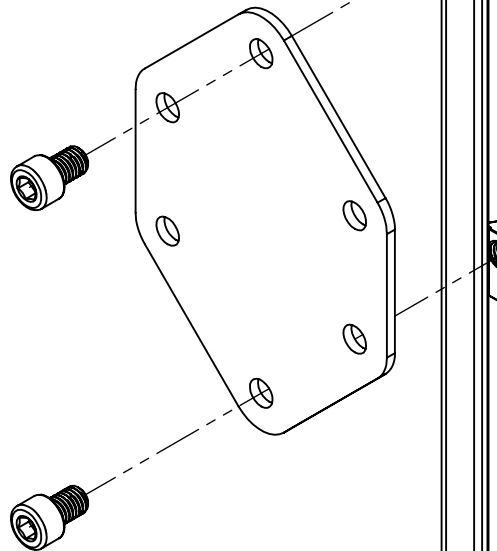

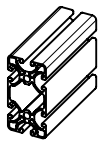

8040 L=1170

1x

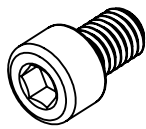

M8x12 (Black)

8x



M8 T-Nut

8x

4

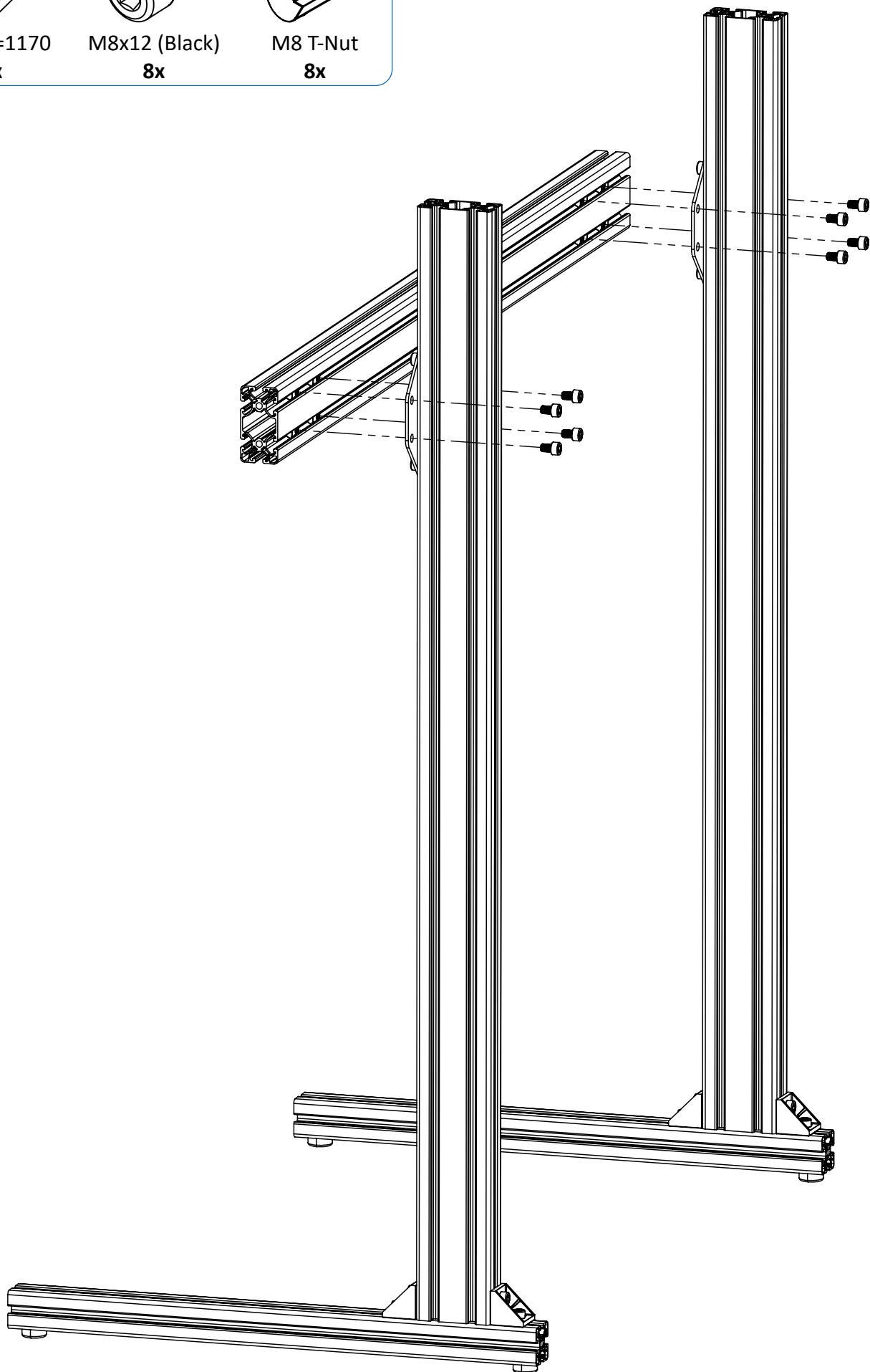

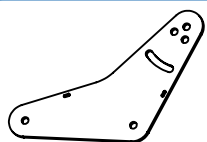

Connector Plate

1x

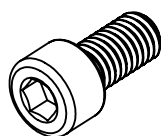

M8x16 (Black)

2x



M8 T-Nut

2x

5

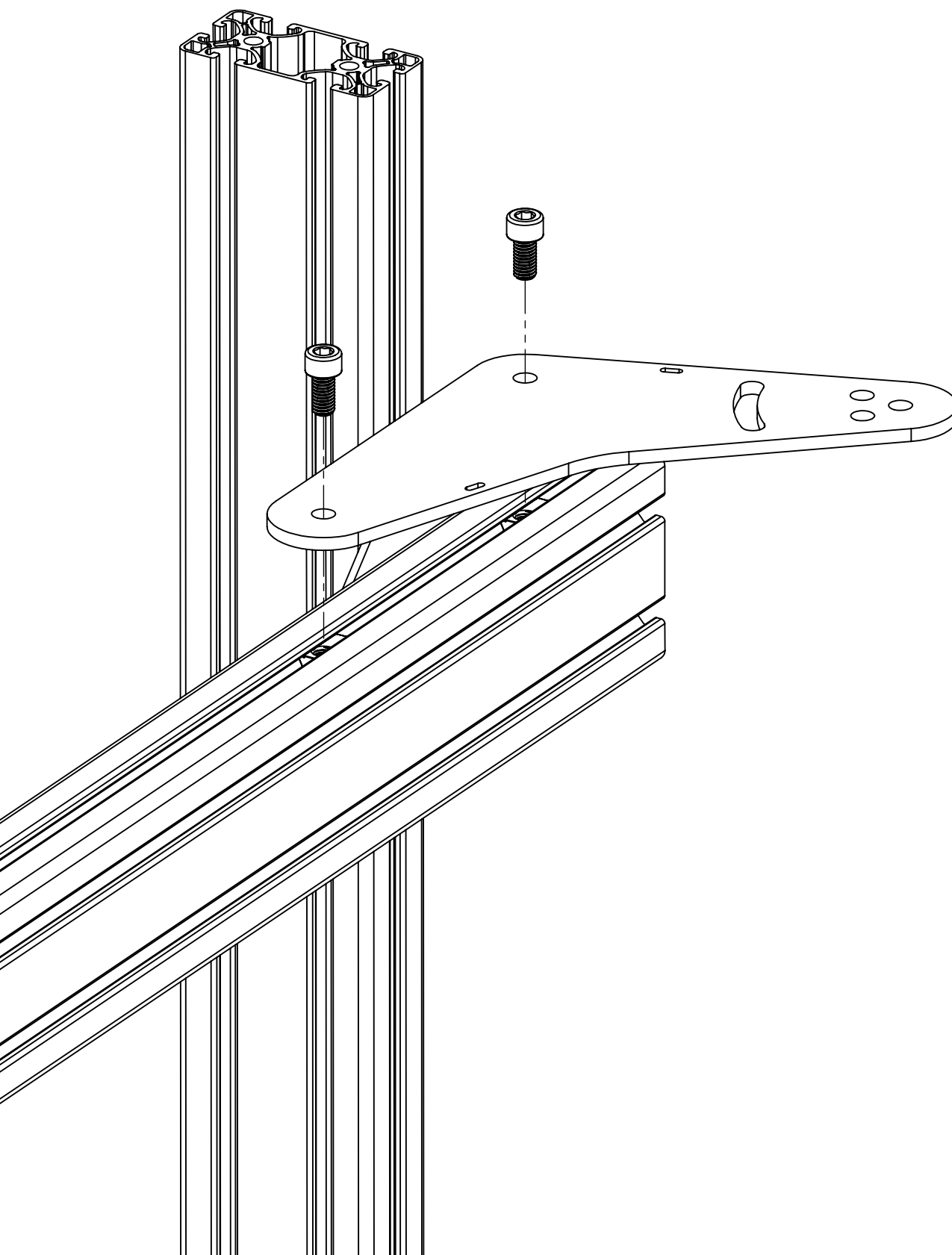

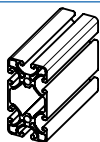

8040 L=580

2x

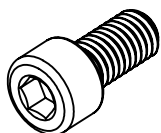

M8x16 (Black)

2x



M8 T-Nut

2x

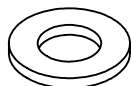

M8 Washer

1x

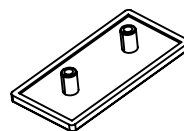

Cover 8040

1x

6

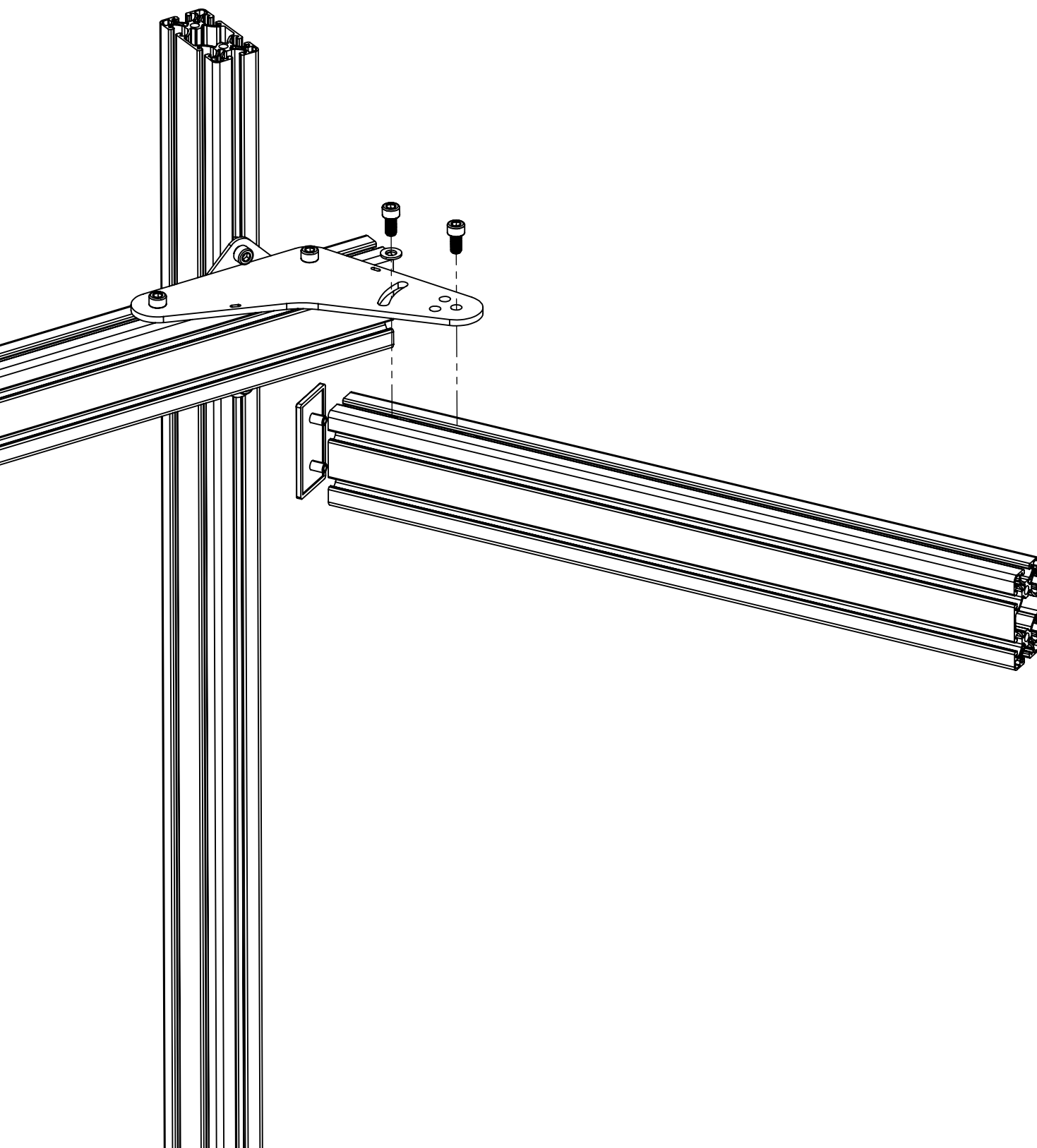



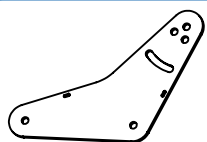

Connector Plate

1x



M8x16 (Black)

4x



M8 T-Nut

4x

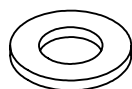

M8 Washer

1x

7

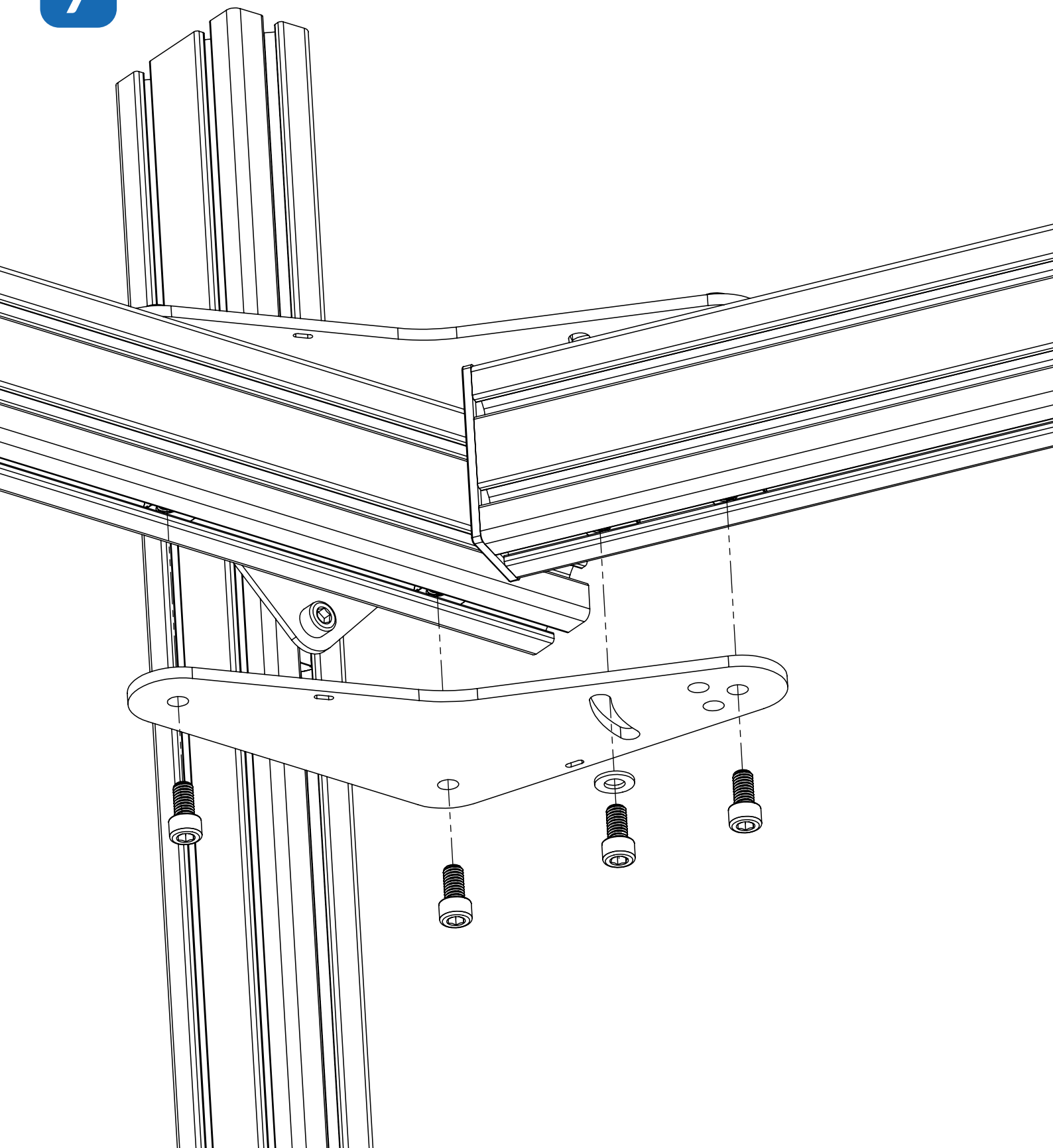

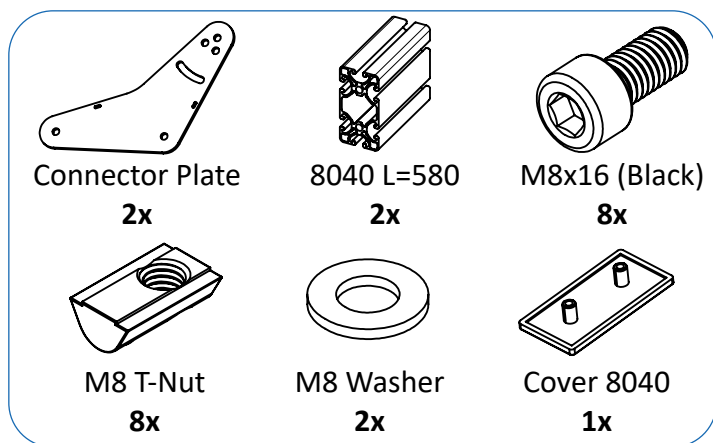

8

Perform step [5](#), [6](#) and [7](#) on the other side of the stand.

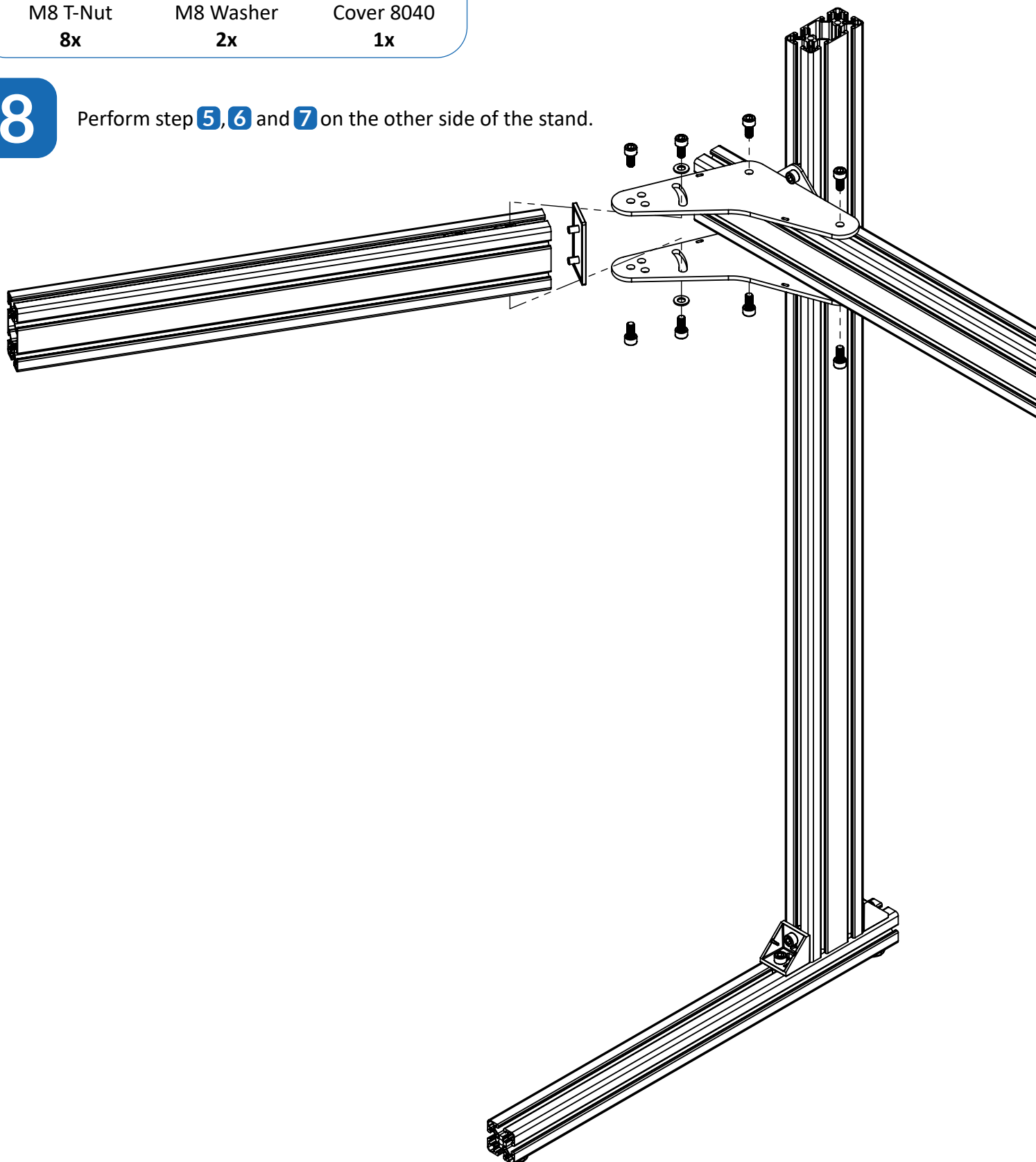

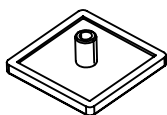

Cover 4040

4x

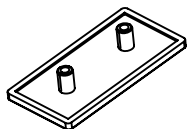

Cover 8040

6x

9

Place all cover caps on the end of the profiles.

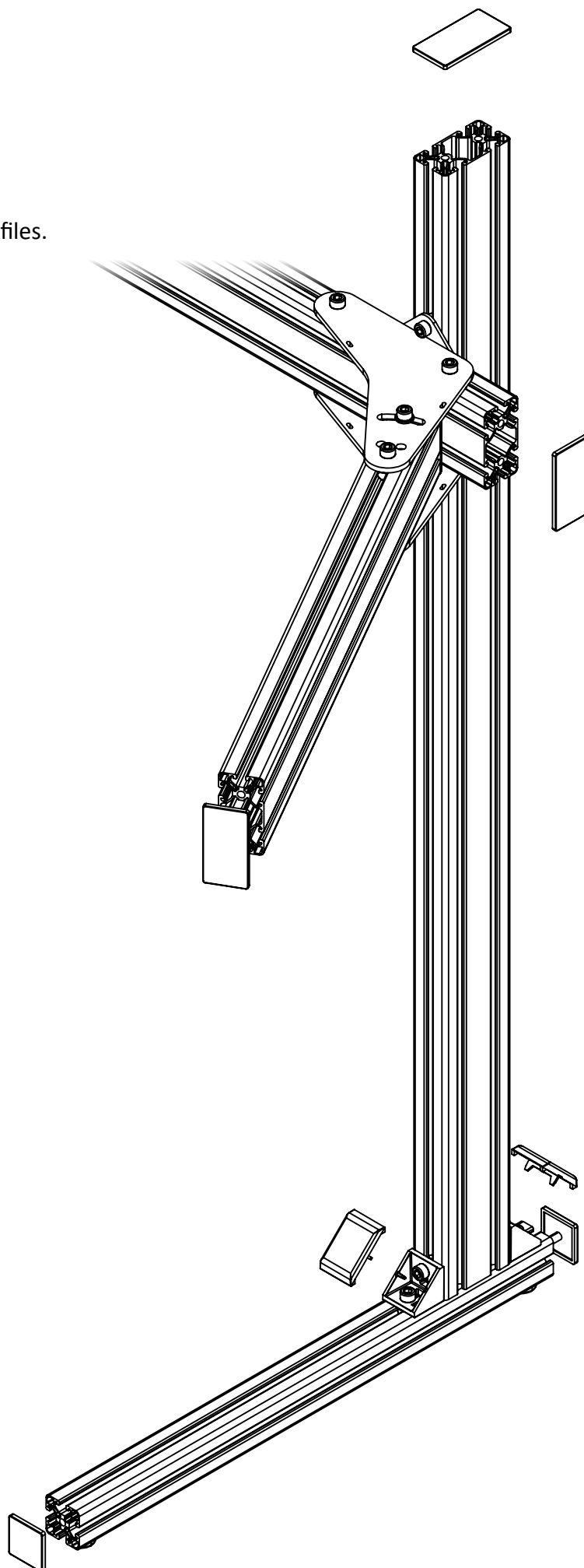

This monitor stand had the option of 'Standard VESA Bracket' and 'Easy Monitor Alignment Kit'. Both these monitor mounting solutions have their own manual. Please proceed the build of your monitor stand by using one of these. Find them at <https://www.treq-sim.com/manuals>

## EASY MONITOR ALIGNMENT KIT

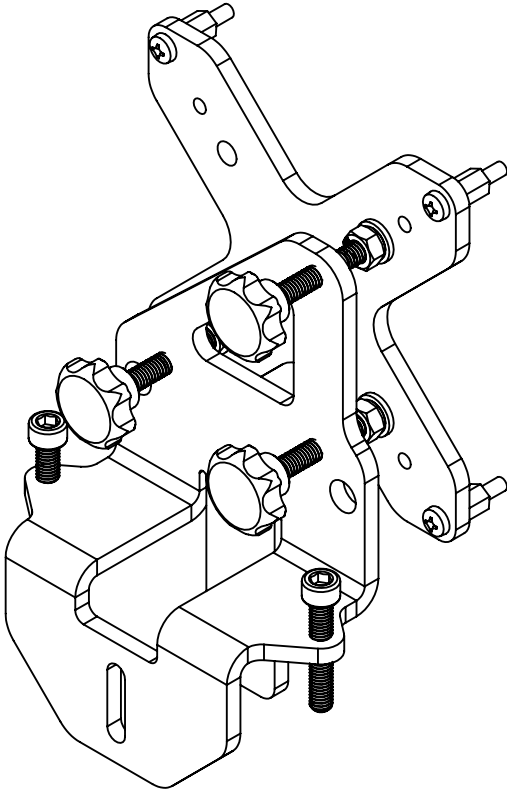

## STANDARD VESA BRACKET

