

# FRONT WHEEL MOUNT

## INSTRUCTION MANUAL

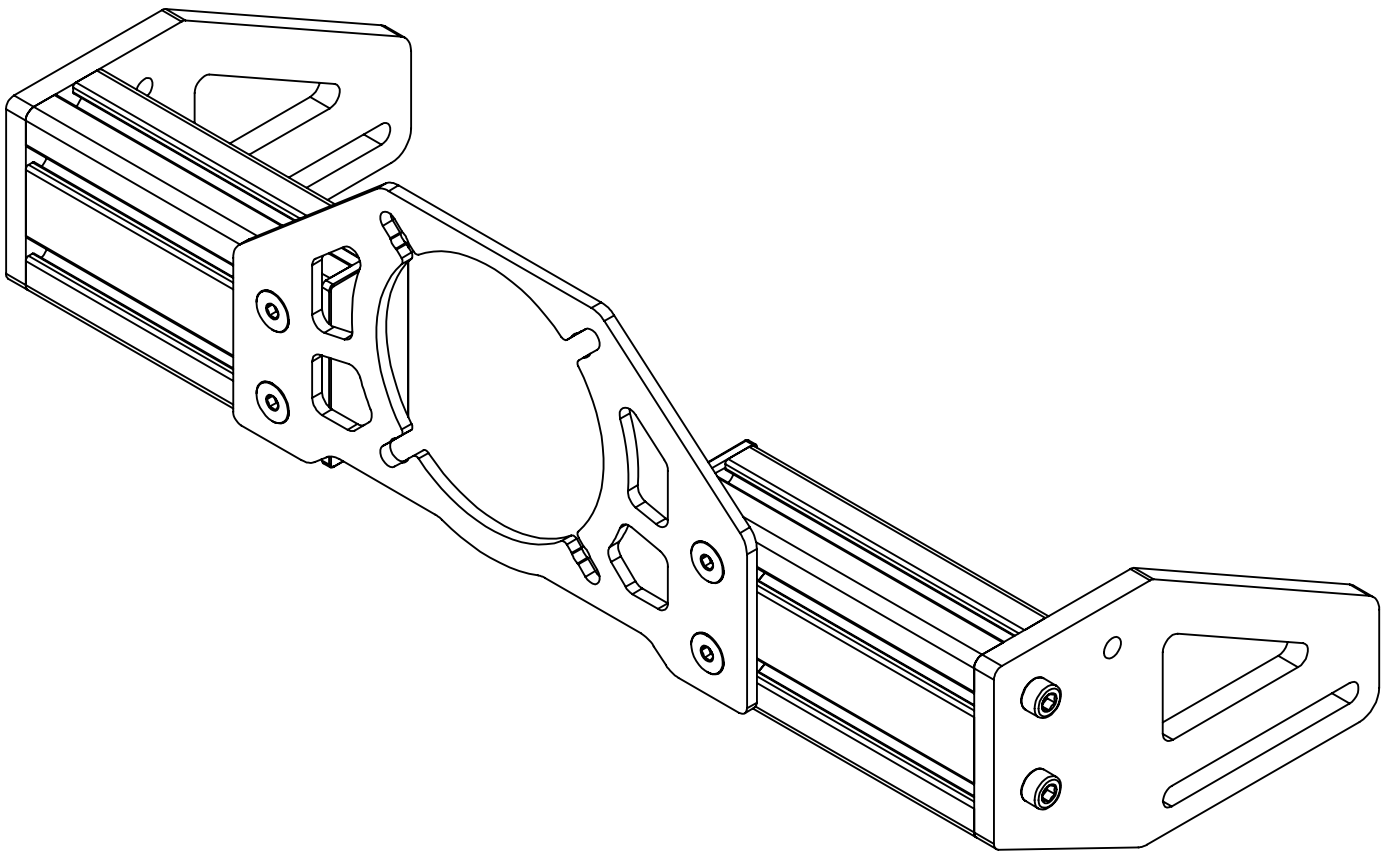

### REQUIRED TOOLS:

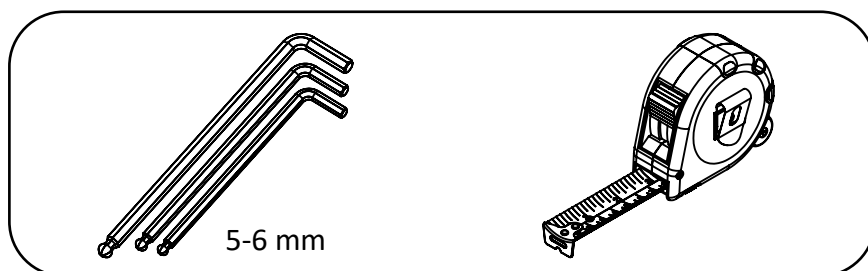

# GENERAL INSTRUCTIONS

The easiest way to mount the T-Slot Click-in-Nuts, is to slide them in from one side of the profile, with the ball facing down. But don't worry if you need to put in a click-in-nut in a profile which has both ends already closed: it is also possible to push them in the T-slot anywhere you like!

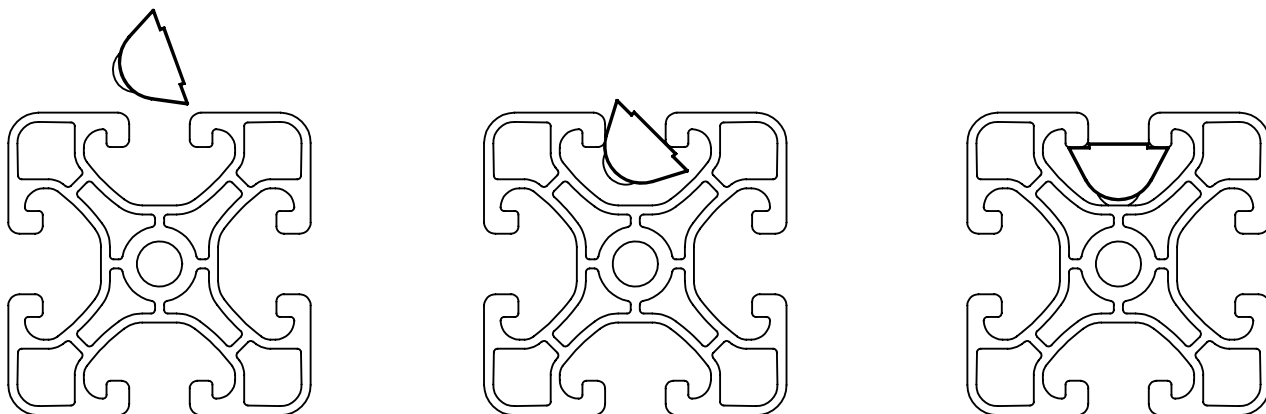

## INCLUDED ITEMS

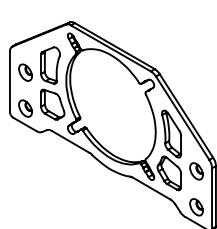

Mounting Plate  
**1x**

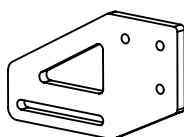

Side Plate  
**2x**

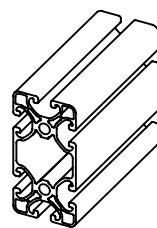

Profile 8040  
**2x**

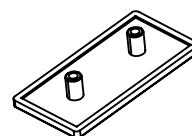

Cover 8040  
**2x**

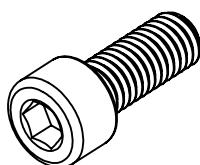

M8x20  
**8x**

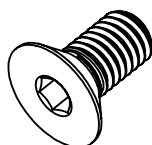

M8x16  
**4x**



M8 T-Nut  
**8x**

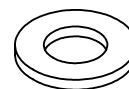

M8 Washer  
**4x**

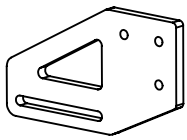

Side Plate  
**2x**

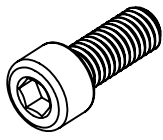

M8x20  
**4x**

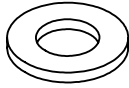

M8 Washer  
**4x**



M8 T-Nut  
**4x**

**1**

Attach the two side plates to the upright profiles of your simulator.

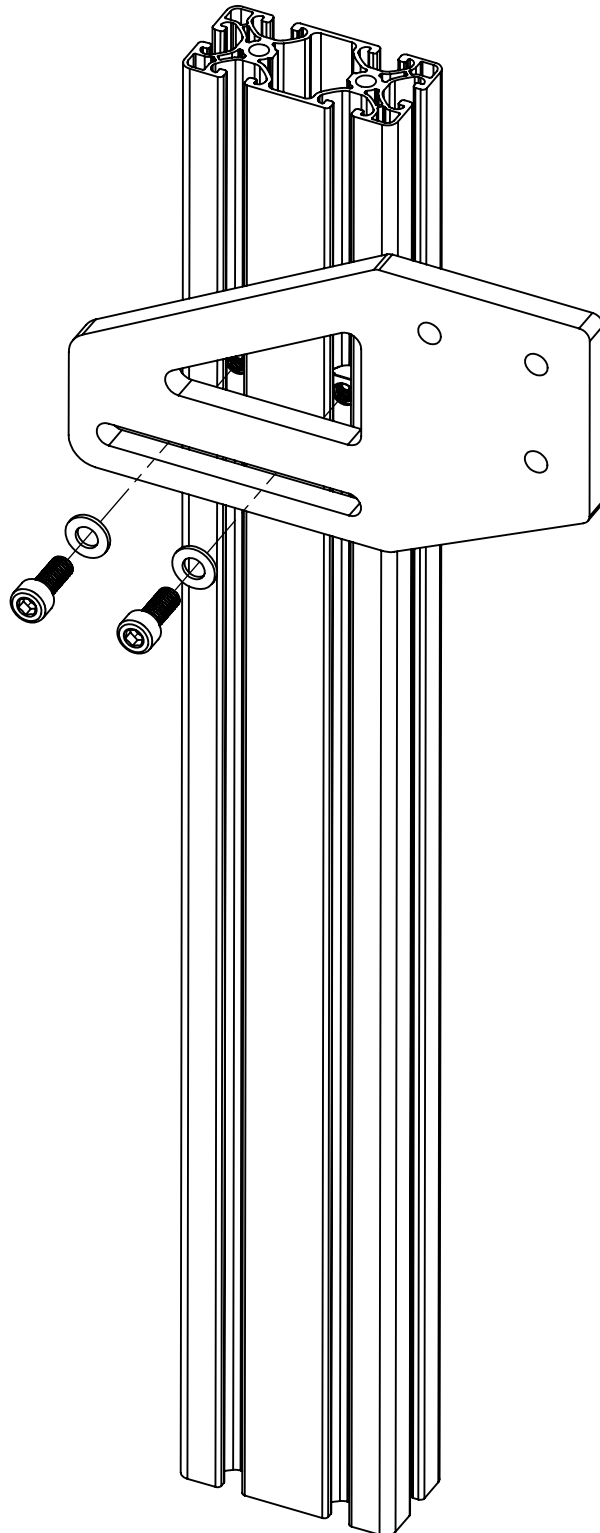
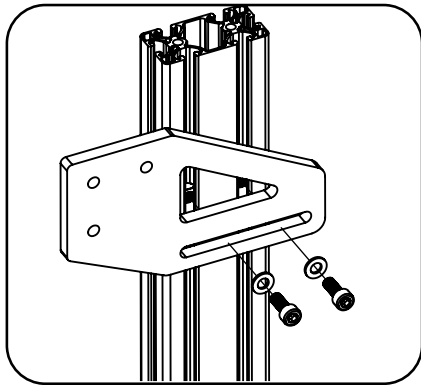

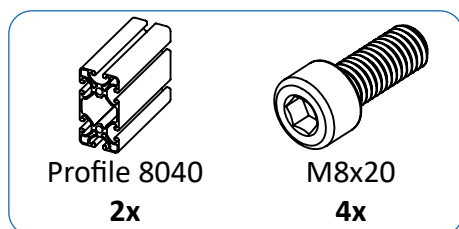

2

Mount the two 8040 profiles through the vertically aligned holes of the Side Plates.

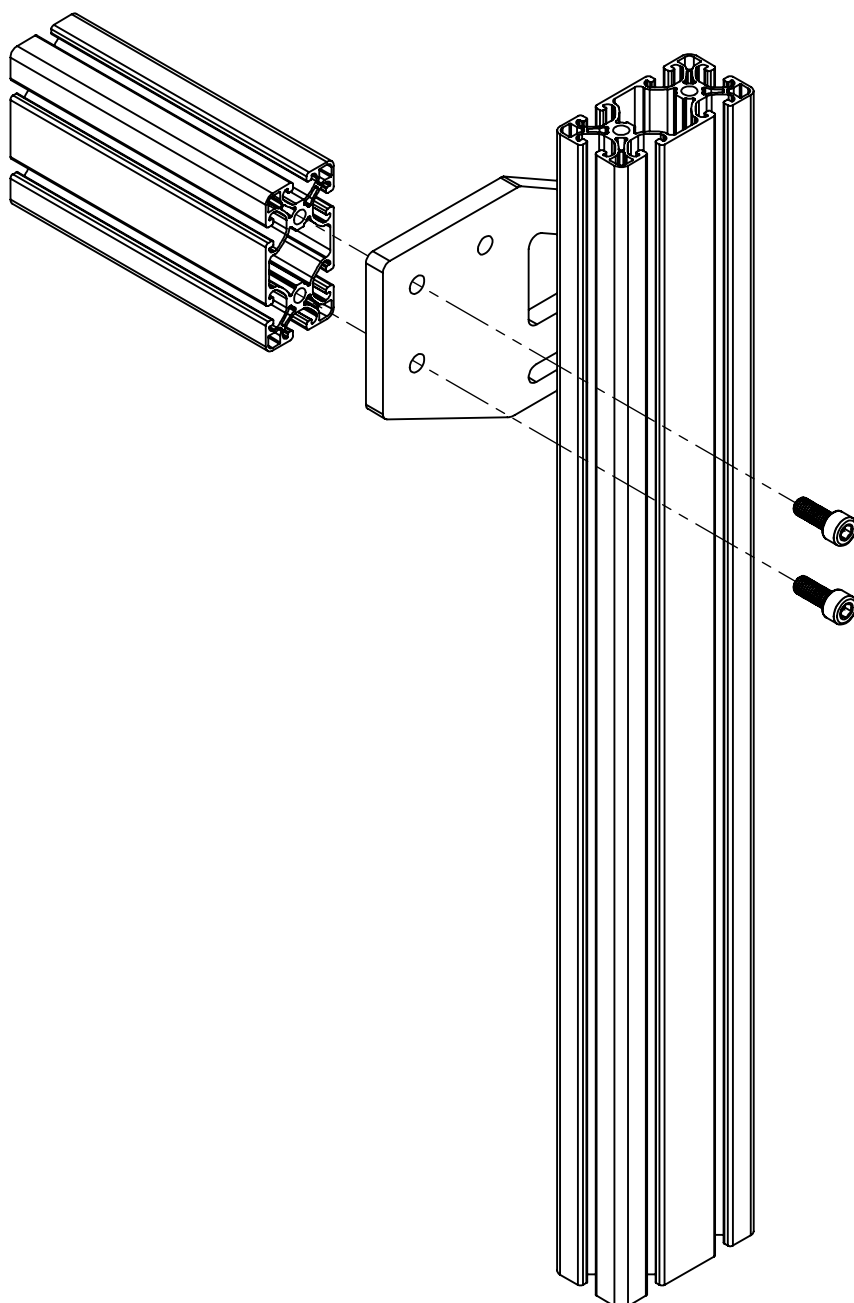
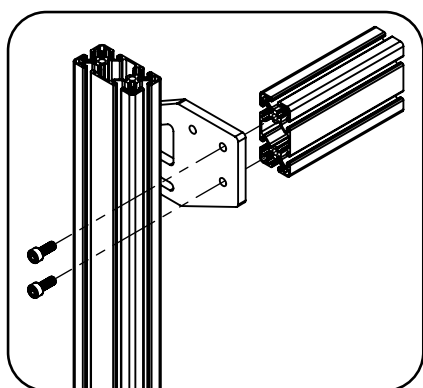

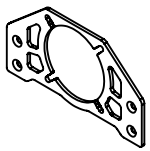

Mounting Plate  
**1x**

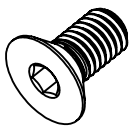

M8x16  
**4x**



M8 T-Nut  
**4x**

**3**

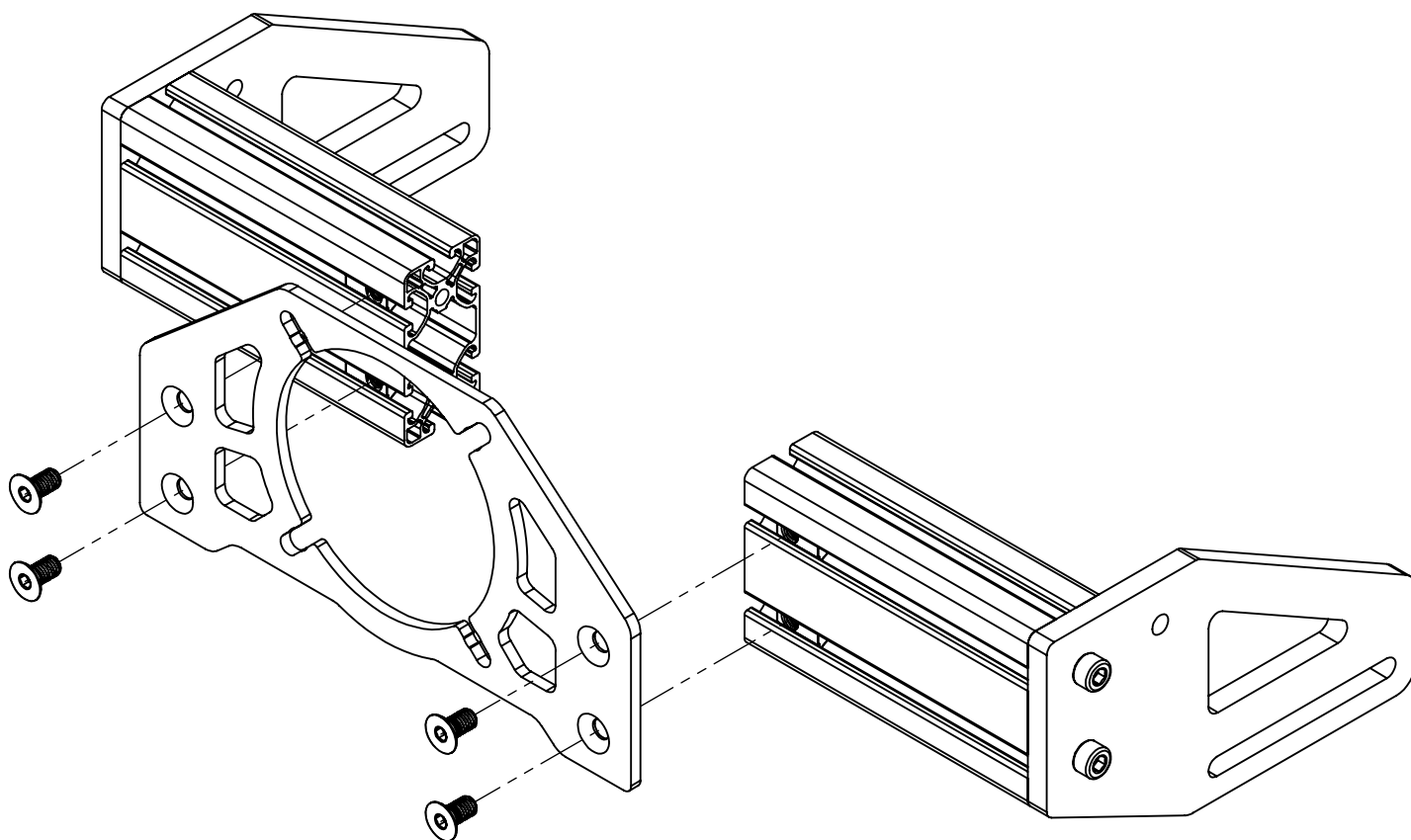

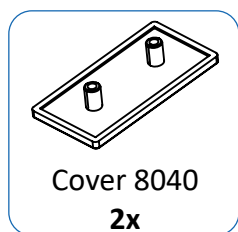

4

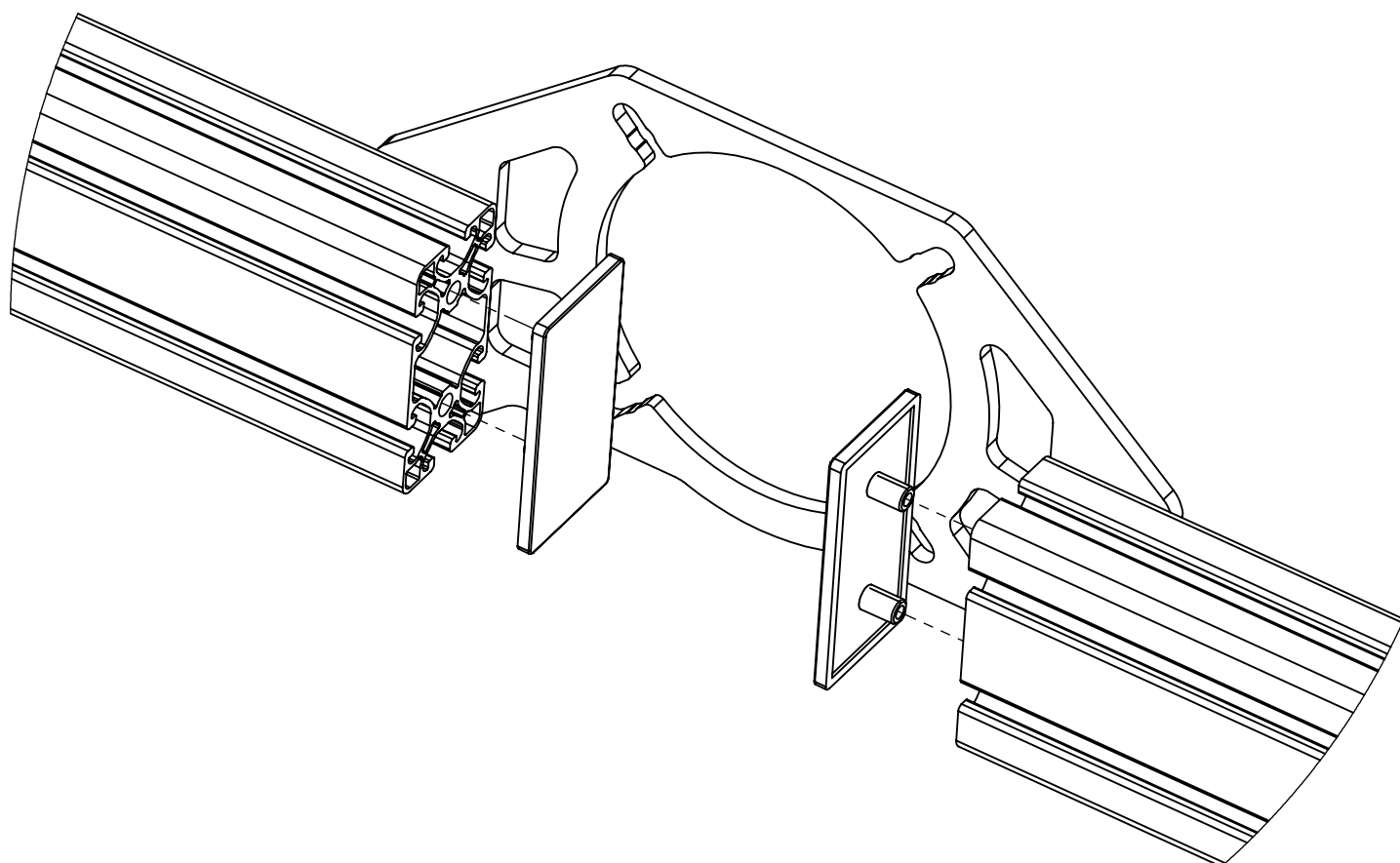

5

Use the spare fasteners to mount your wheel base to the assembly.