

TRIPLE MONITOR STAND 8040

INSTRUCTION MANUAL

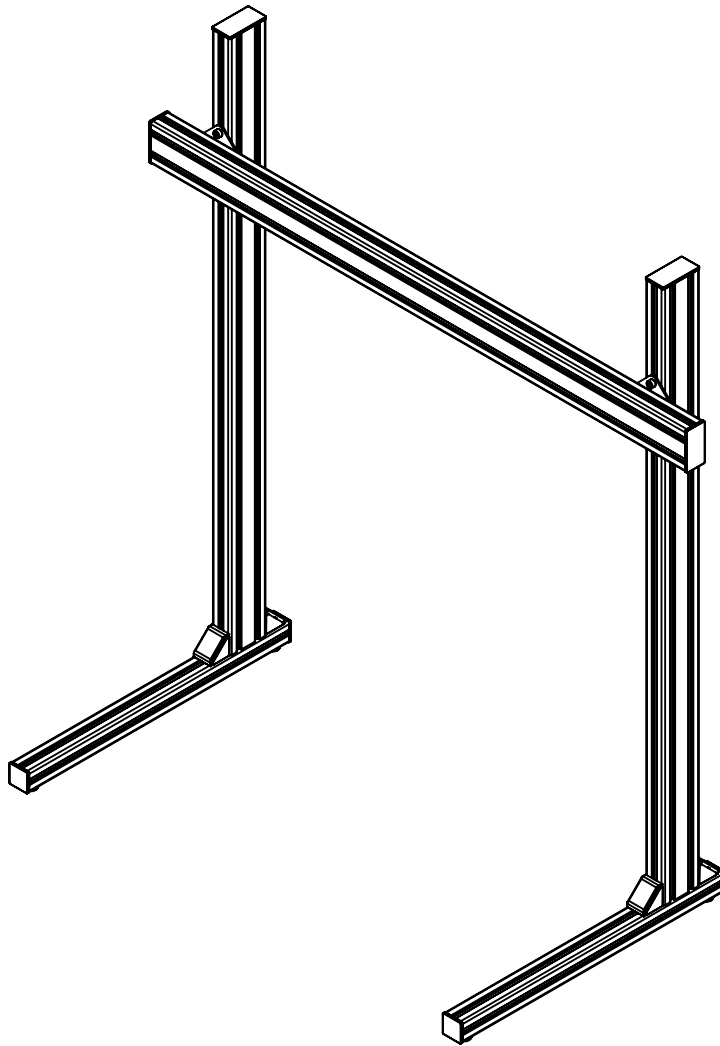

REQUIRED TOOLS:

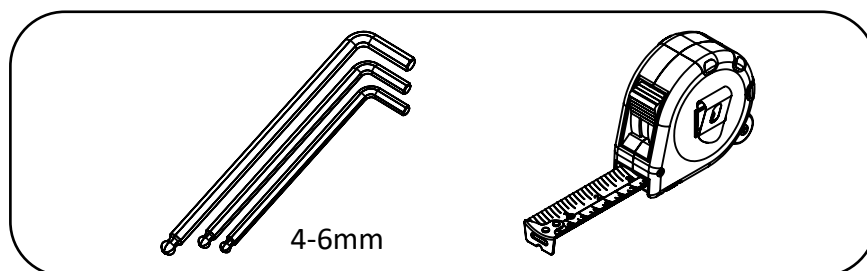

GENERAL INSTRUCTIONS

The easiest way to mount the T-Slot Click-in-Nuts, is to slide them in from one side of the profile, with the ball facing down. But don't worry if you need to put in a click-in-nut in a profile which has both ends already closed: it is also possible to push them in the T-slot anywhere you like!

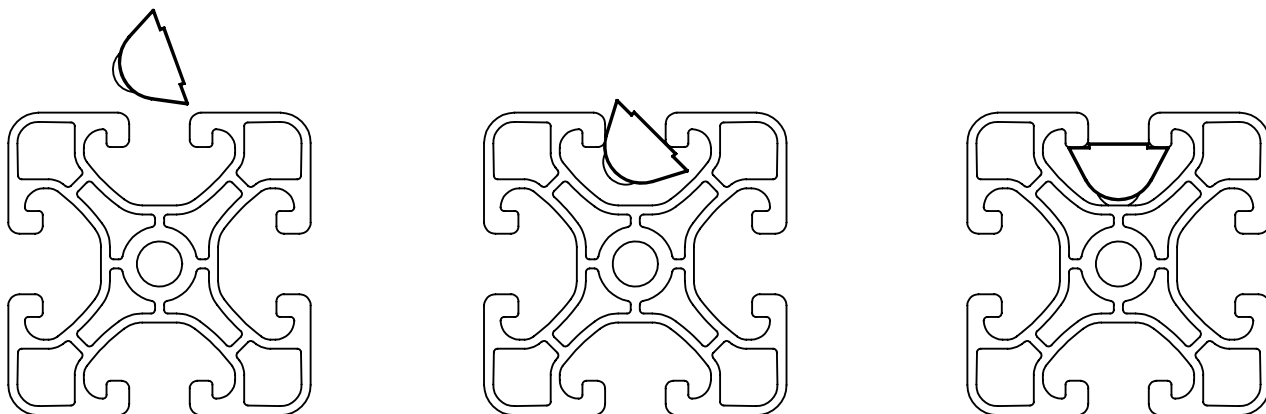

INCLUDED ITEMS

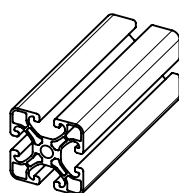

4040 L=570

2x

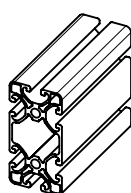

8040 L=1170

3x

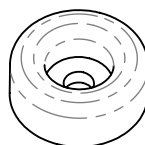

Rubber Foot

4x

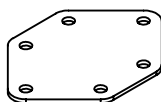

Perpendicular Plate

2x

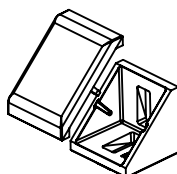

Corner Bracket

4x

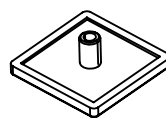

Cover 4040

4x

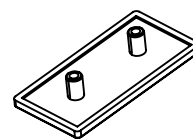

Cover 8040

4x

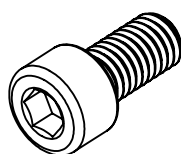

M8x16

8x

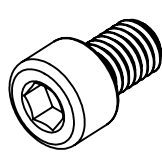

M8x12 (Black)

12x



M5x12

4x



M8 T-Nut

20x

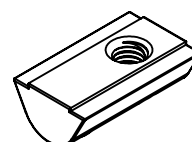

M5 T-Nut

4x

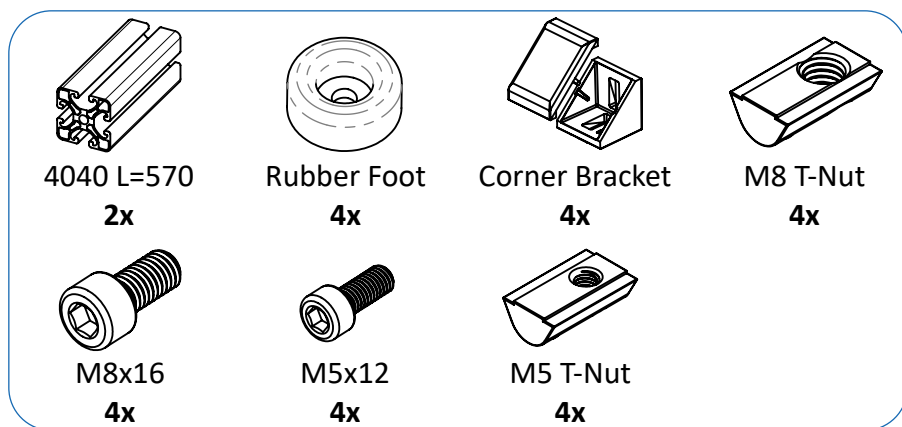

1

Attach the rubber feet and the corner brackets to the 4040 L=570 profiles. Perform this step twice.

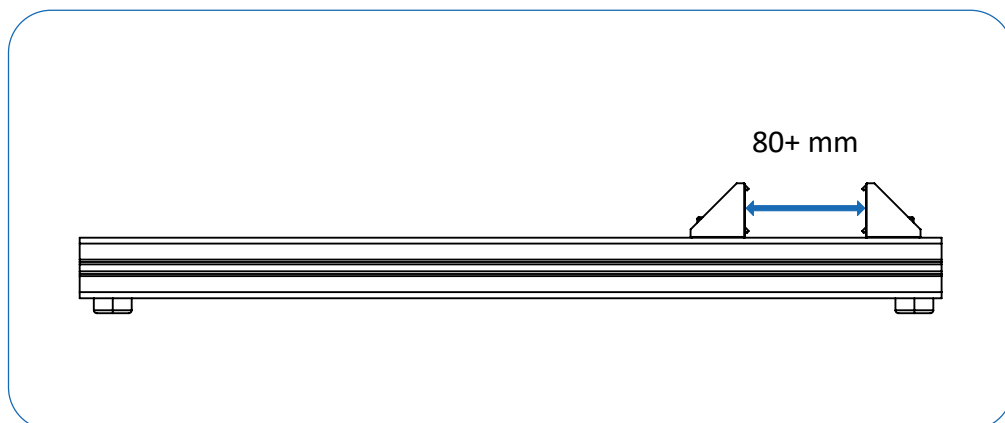
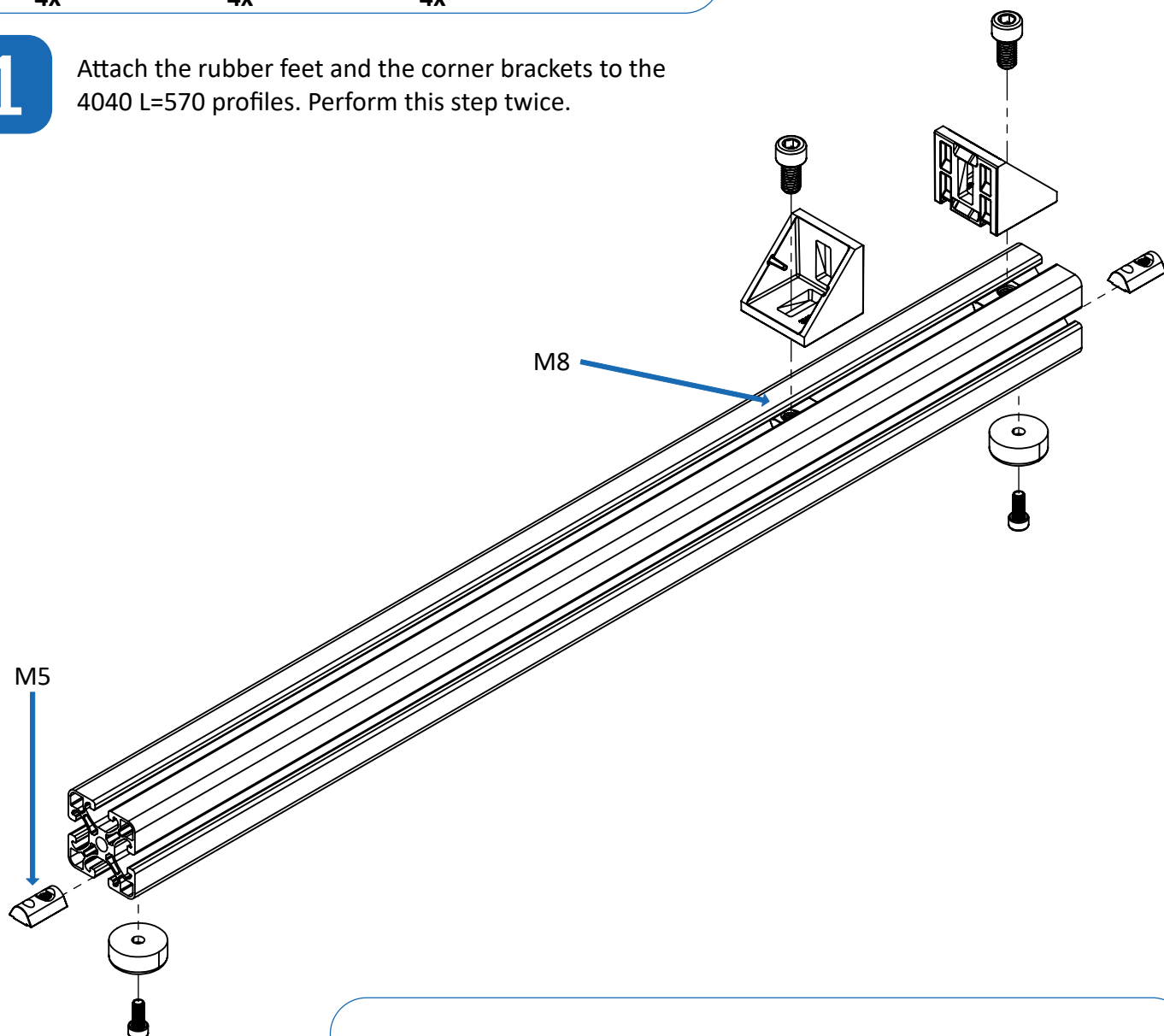

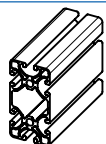

8040 L=1170

2x



M8x16

4x



M8 T-Nut

4x

2

Mount the 8040 profiles.
Perform this step twice.

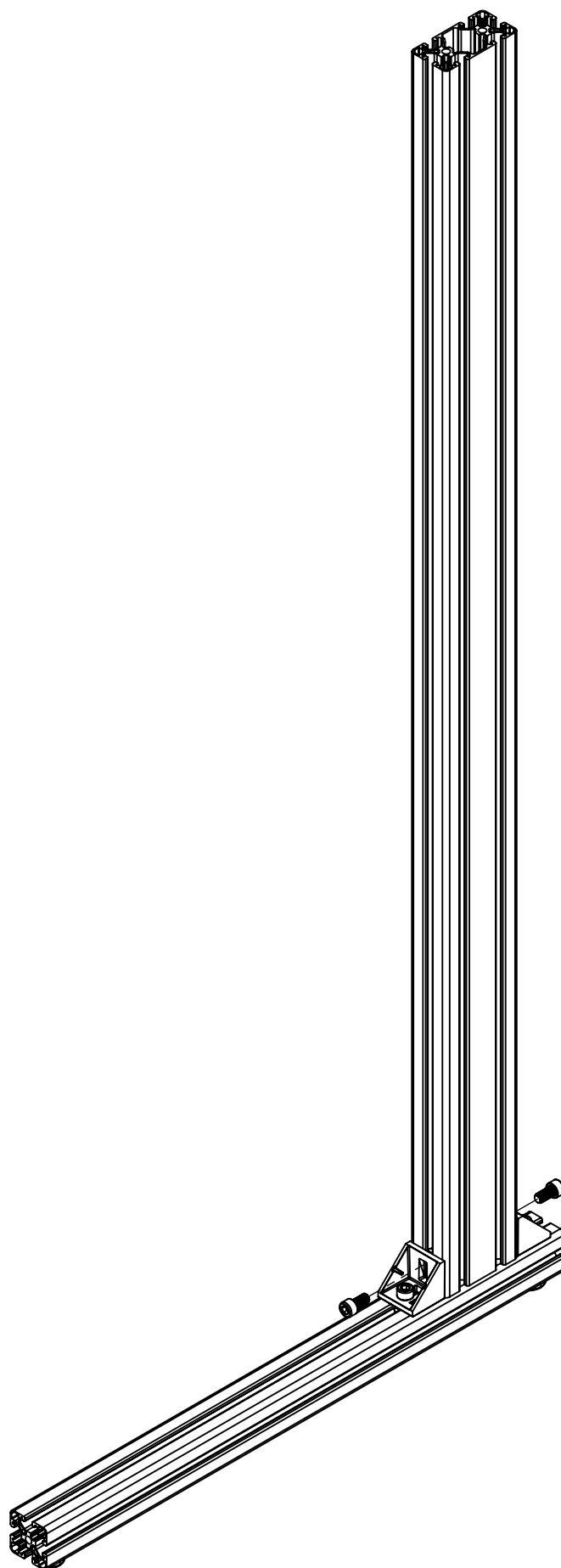

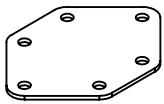

Perpendicular Plate
2x

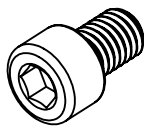

M8x12 (Black)
4x



M8 T-Nut
4x

3

Perform this step twice.

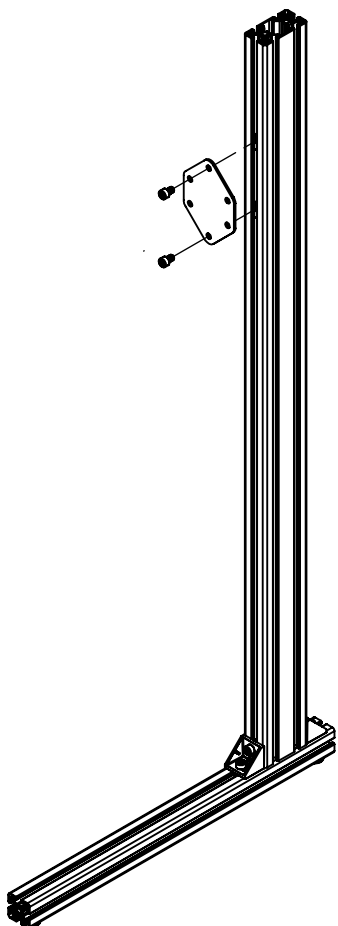
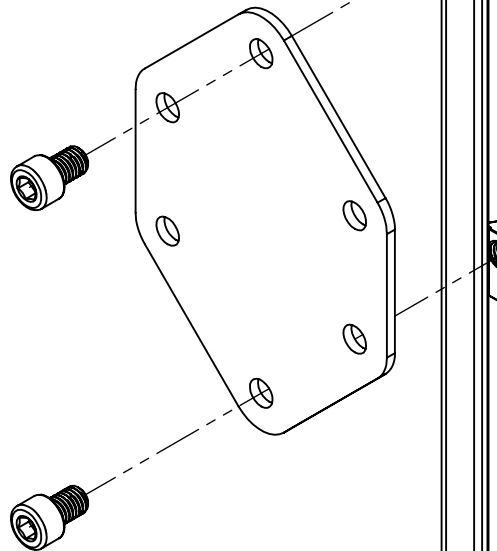

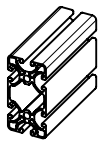

8040 L=1170
1x

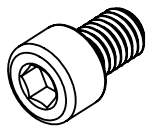

M8x12 (Black)
8x



M8 T-Nut
8x

4

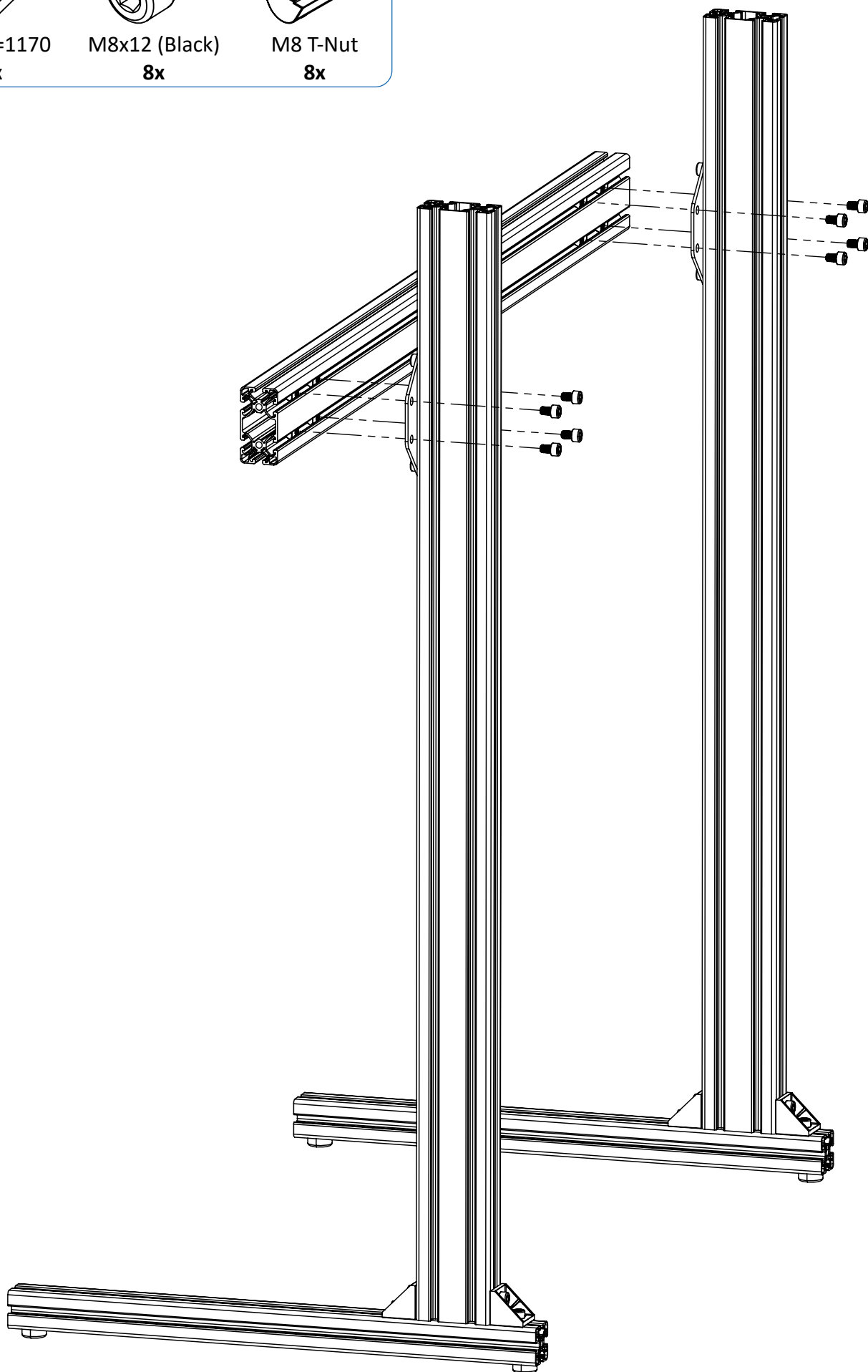

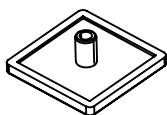

Cover 4040

4x

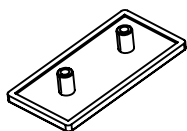

Cover 8040

4x

5

Place all cover caps on the end of the profiles.

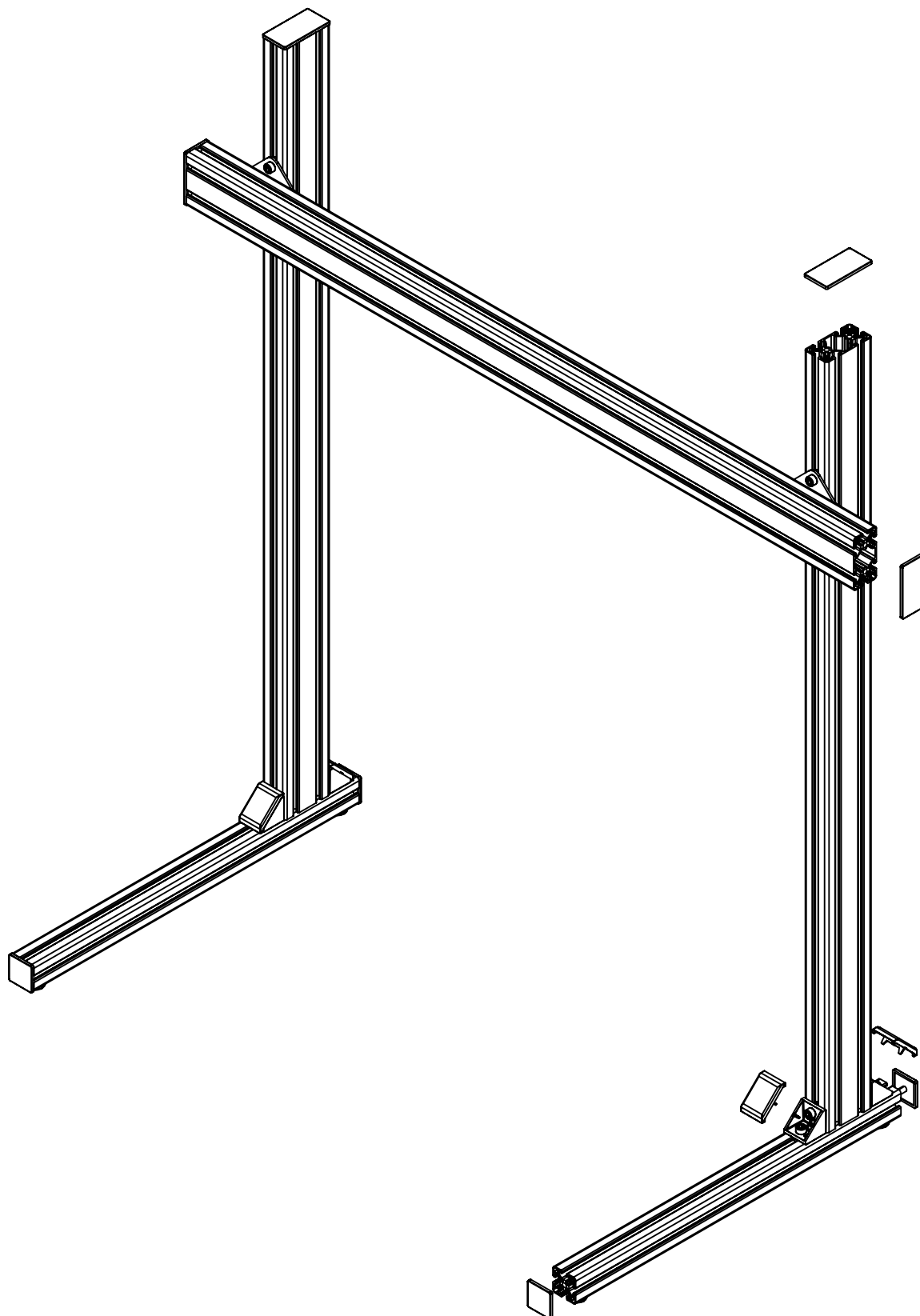

6

This monitor stand had the option of 'Standard VESA Bracket' and 'Easy Monitor Alignment Kit'. Both these monitor mounting solutions have their own manual. Please proceed the build of your monitor stand by using one of these. Find them at <https://www.treq-sim.com/manuals>

EASY MONITOR ALIGNMENT KIT

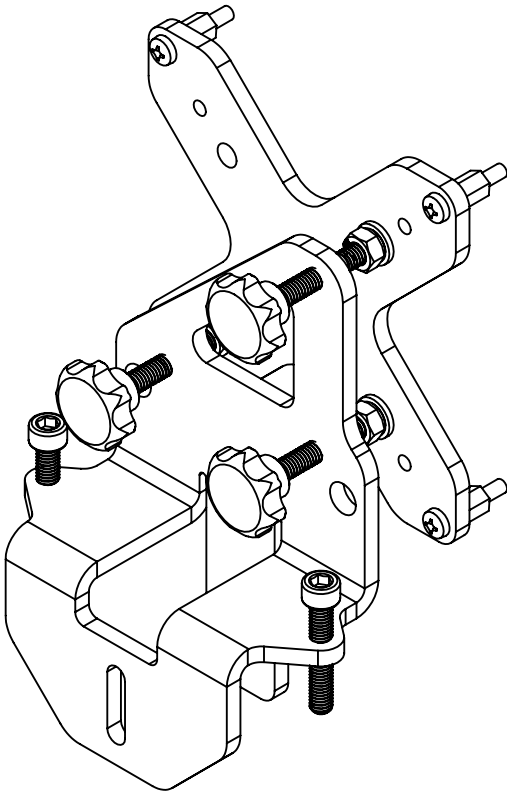

STANDARD VESA BRACKET

