

UNIFIED SINGLE MONITOR MOUNT 8040

INSTRUCTION MANUAL

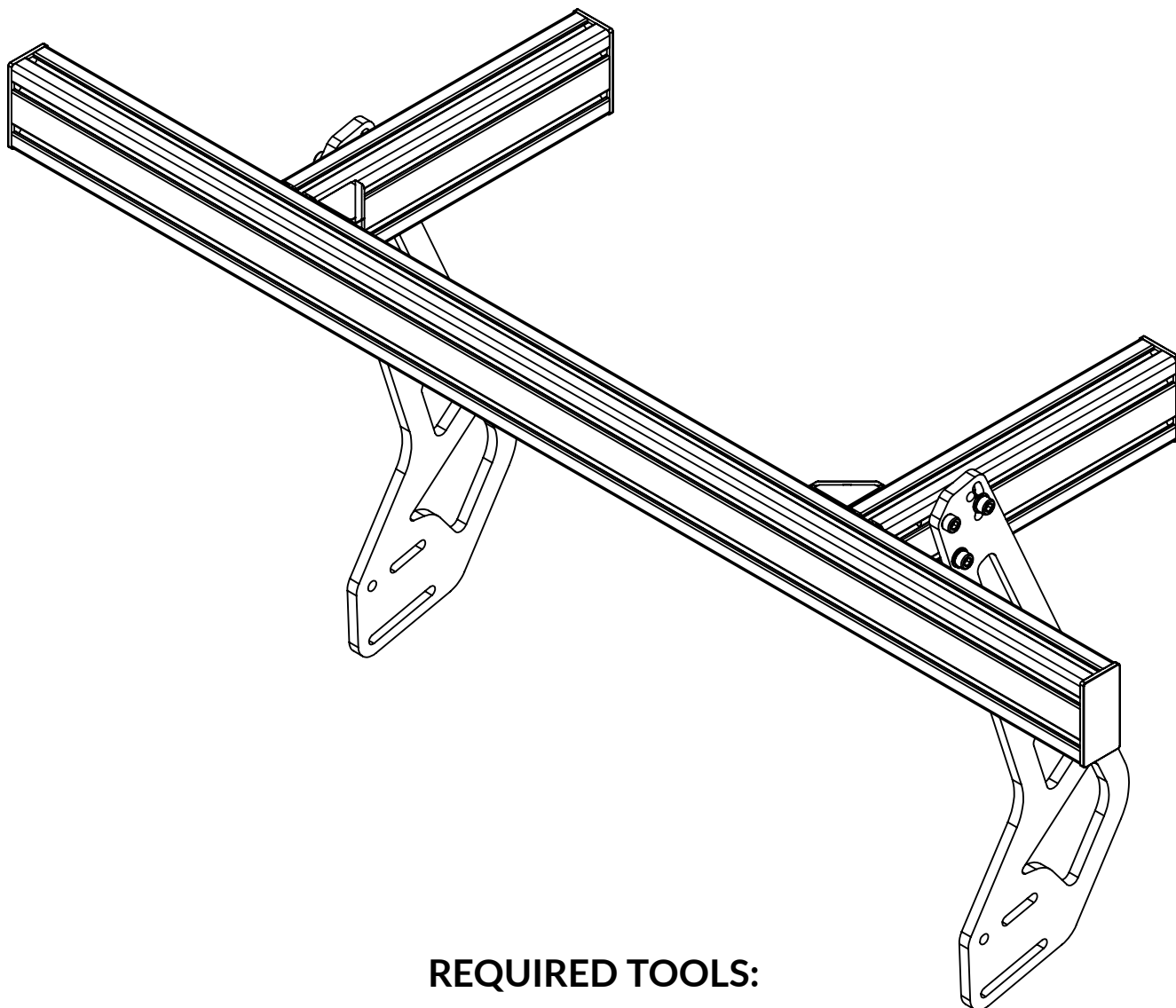

REQUIRED TOOLS:

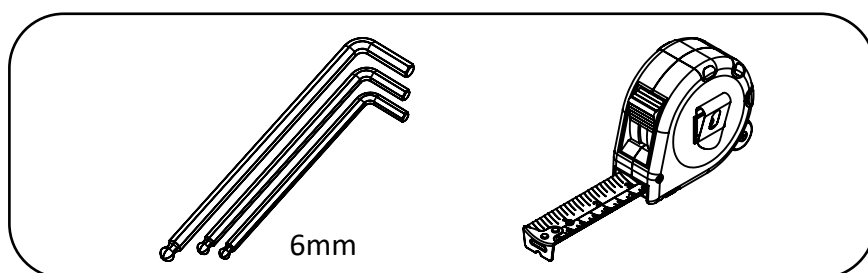

GENERAL INSTRUCTIONS

The easiest way to mount the T-Slot Click-in-Nuts, is to slide them in from one side of the profile, with the ball facing down. But don't worry if you need to put in a click-in-nut in a profile which has both ends already closed: it is also possible to push them in the T-slot anywhere you like!

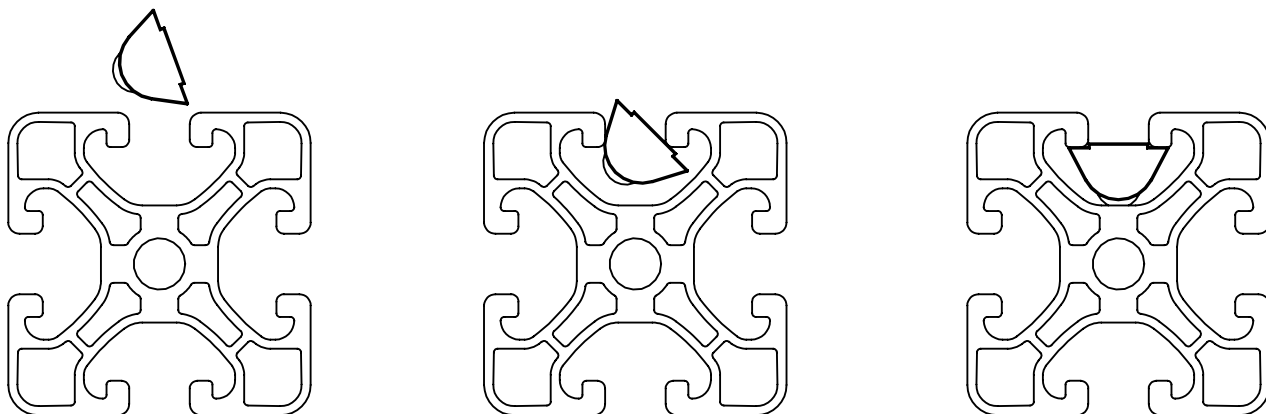

INCLUDED ITEMS

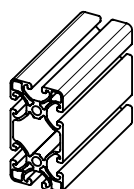

8040 L=320
2x

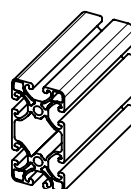

8040 L=1170
1x

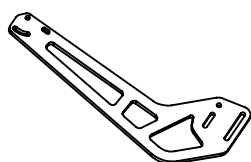

Unified Bracket
2x

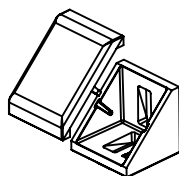

Corner Bracket
4x

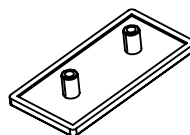

Cover 8040
4x

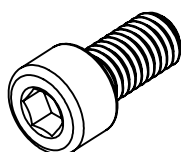

M8x16
8x

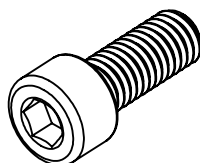

M8x20 (Black)
12x



M8 T-Nut
20x

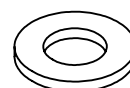

M8 Washer
8x

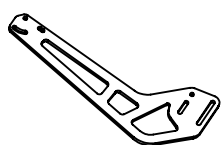

Unified Bracket
2x



M8 T-Nut
6x

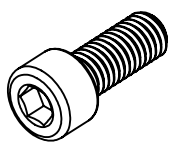

M8x20
6x

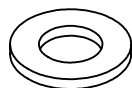

M8 Washer
4x

1

Mount the Unified Brackets to the uprights of your rig.

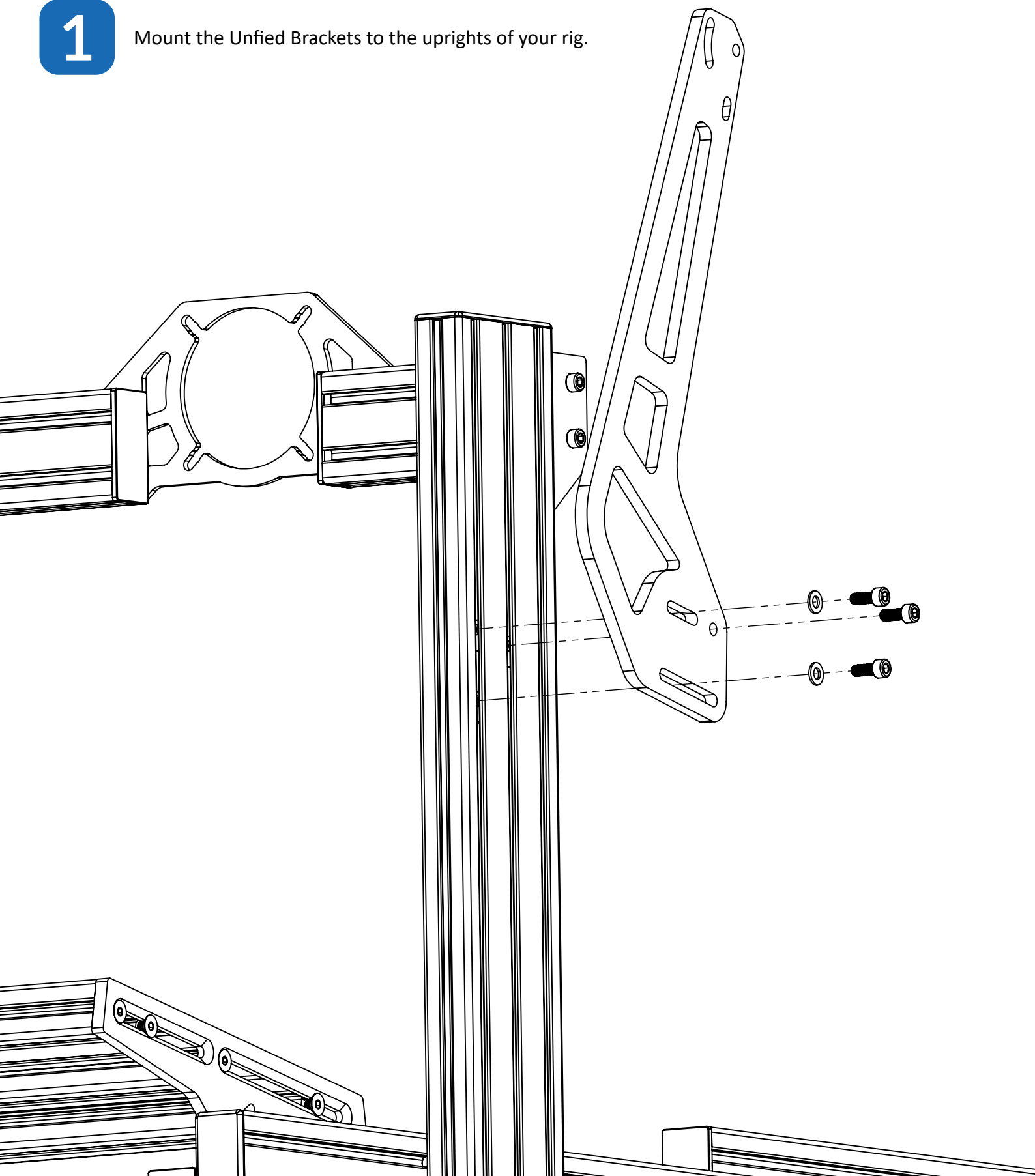

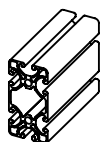

8040 L=320

2x



M8 T-Nut

4x

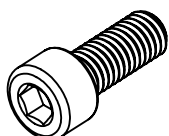

M8x20

6x

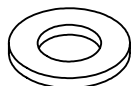

M8 Washer

4x

2

Attach the two small profiles to the Unified Brackets.

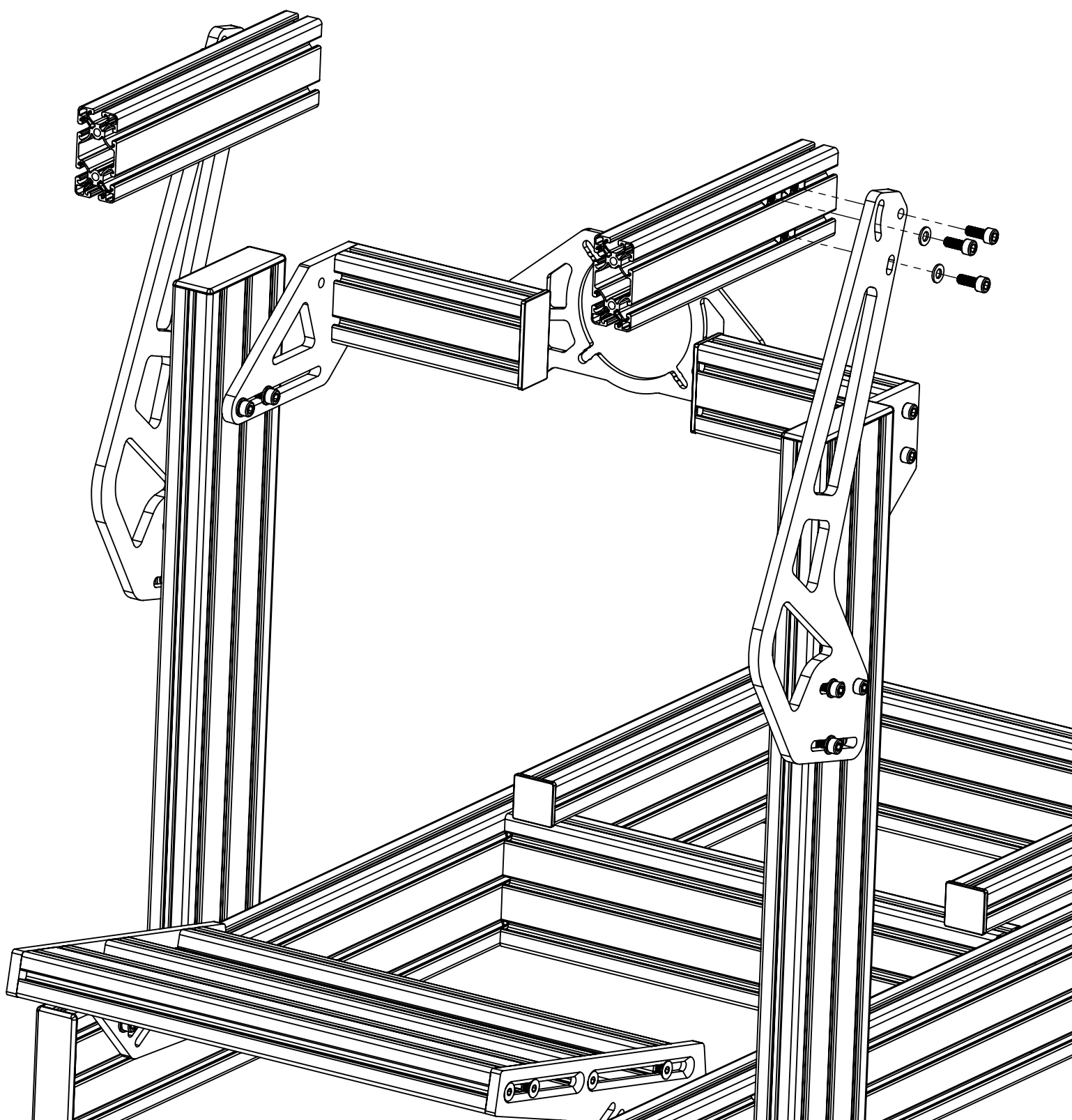

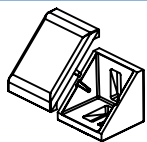

Corner Bracket

4x



M8 T-Nut

4x

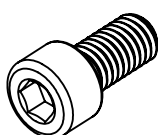

M8x16

4x

3

Attach the Corner Brackets to the 8040 L=320 profiles.

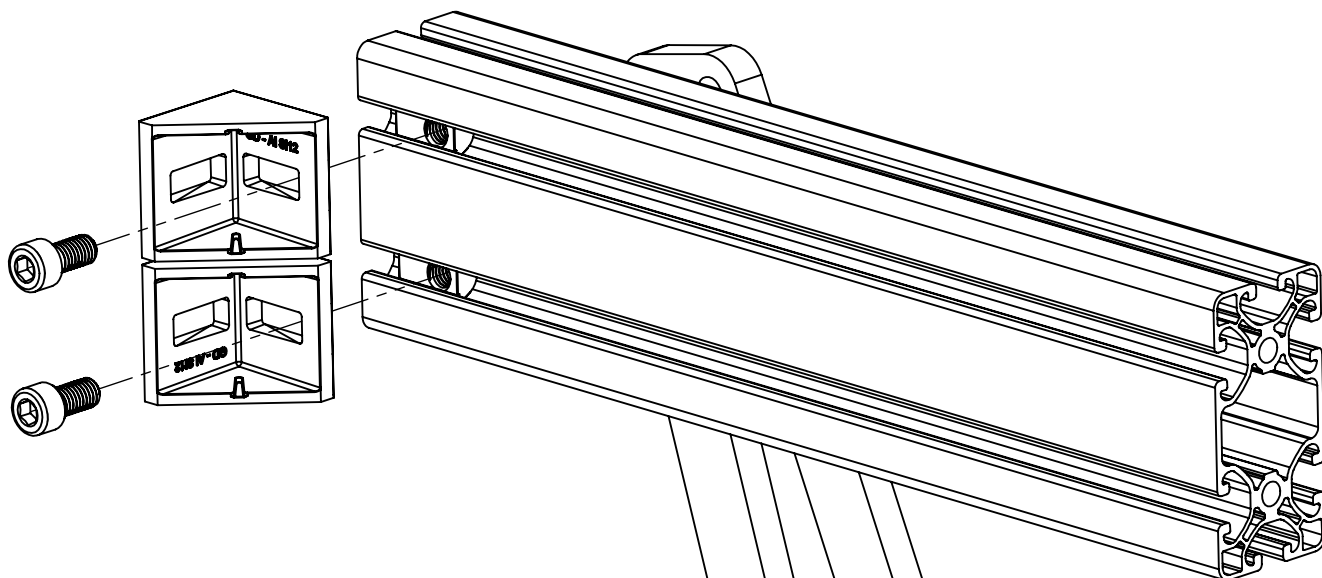

Make sure the corner brackets are in line with the end of the profile, or 'pulled back' a very short distance (maximum of 1 mm), as displayed on the left. They must not reach further than the end of the profile, as displayed on the right. This weakens the construction.

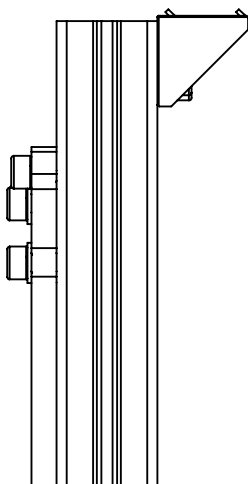
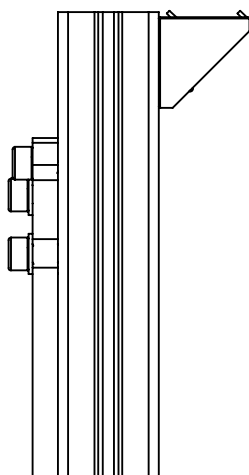

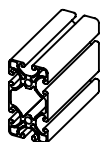

8040 L=1170

1x



M8 T-Nut

4x



M8x16

4x

4

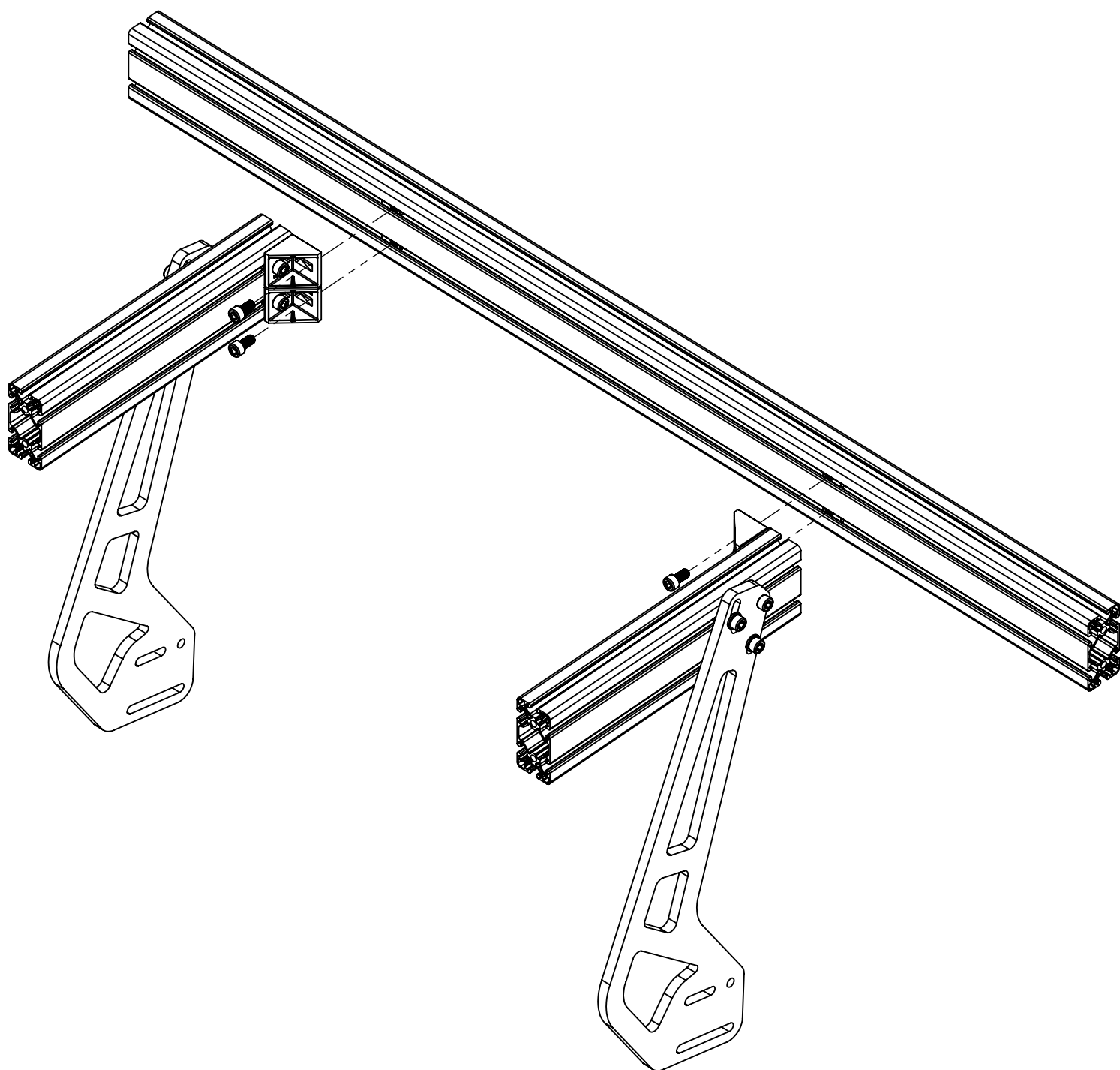

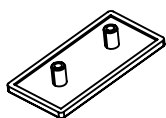

Cover 8040
4x

5

Place all remaining cover caps on the mount.

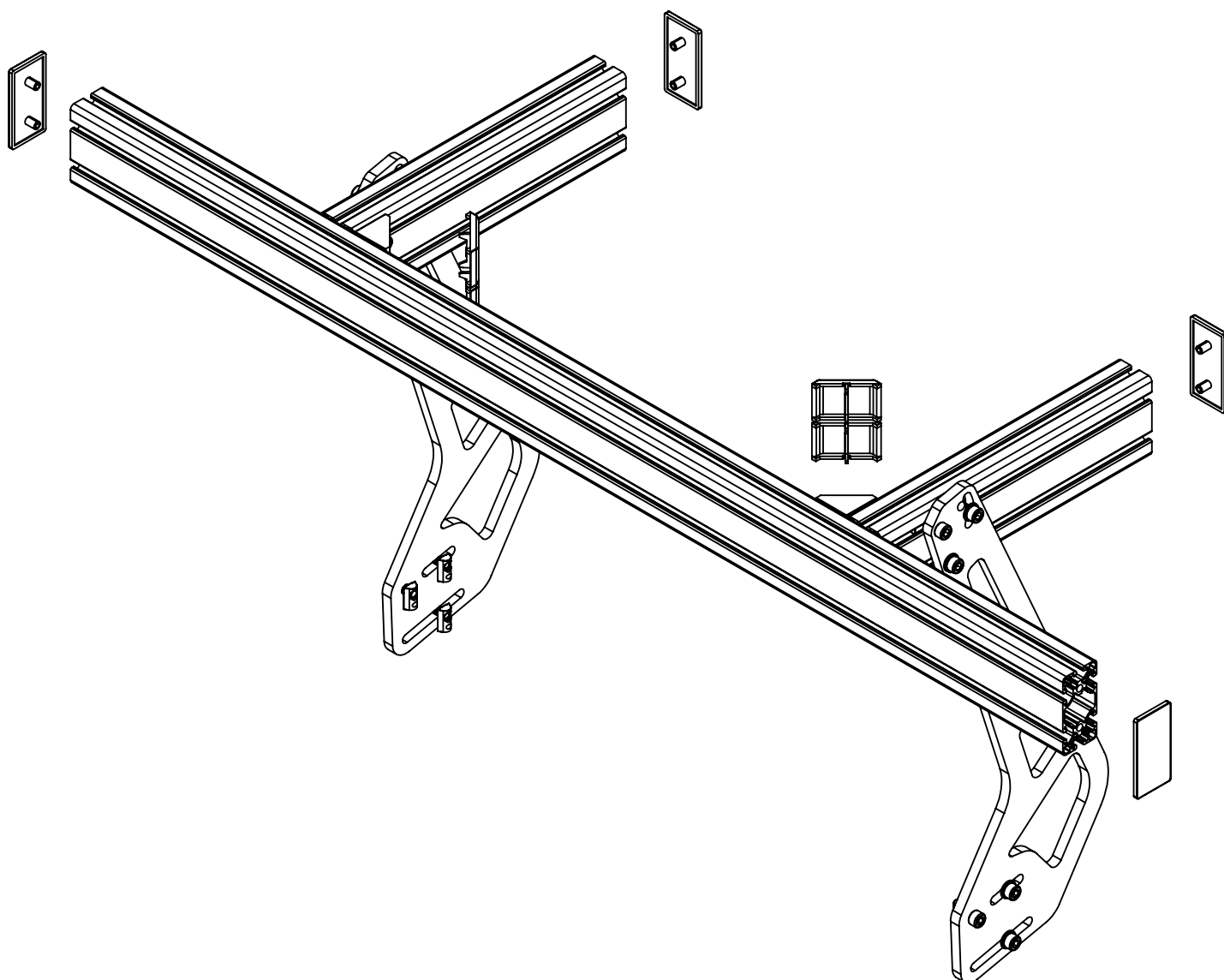

6

This monitor mount had the option of 'Standard VESA Bracket' and 'Easy Monitor Alignment Kit'. Both these monitor mounting solutions have their own manual. Please proceed the build of your monitor stand by using one of these. Find them at <https://www.treq-sim.com/manuals>

EASY MONITOR ALIGNMENT KIT

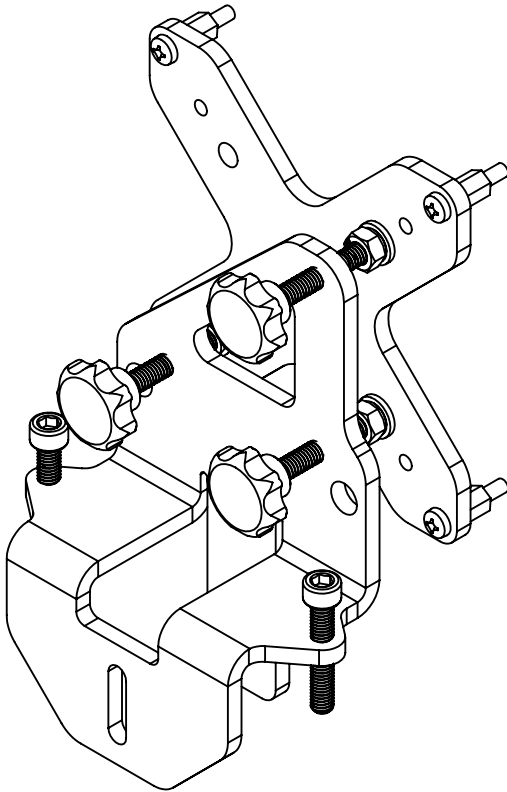

STANDARD VESA BRACKET

