

CASTER WHEEL

INSTRUCTION MANUAL

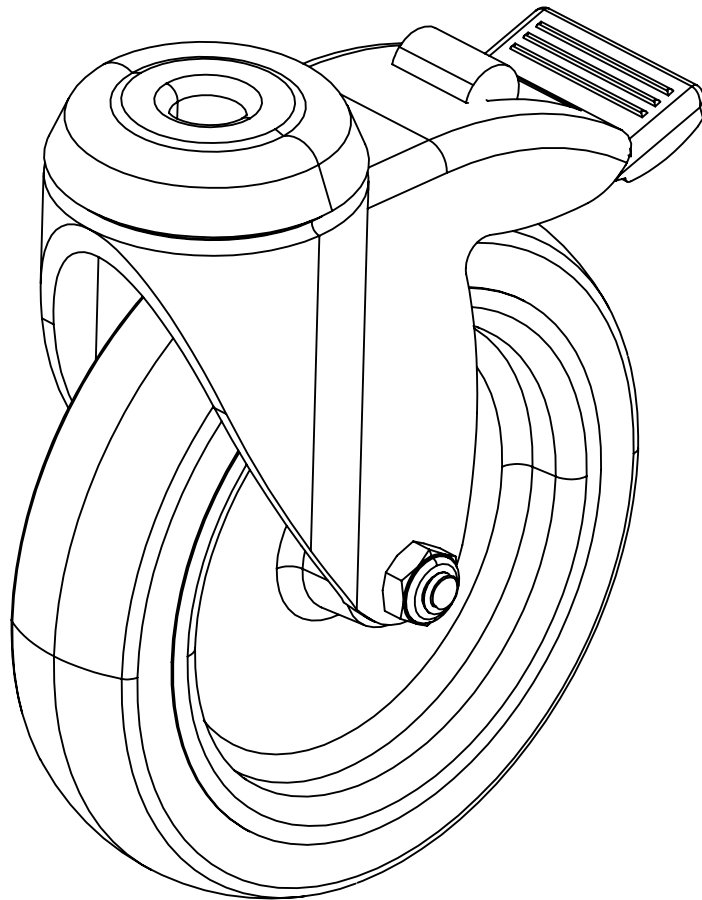

REQUIRED TOOLS:

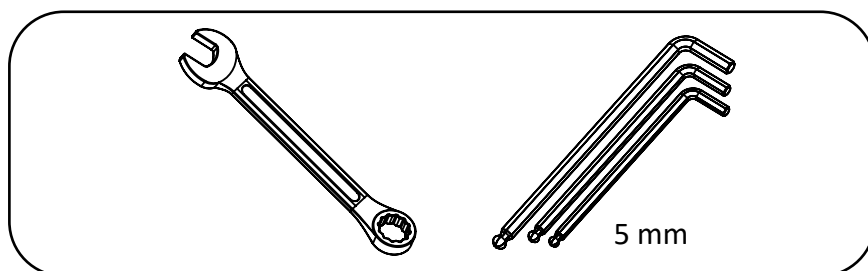

GENERAL INSTRUCTIONS

The easiest way to mount the T-Slot Click-in-Nuts, is to slide them in from one side of the profile, with the ball facing down. But don't worry if you need to put in a click-in-nut in a profile which has both ends already closed: it is also possible to push them in the T-slot anywhere you like!

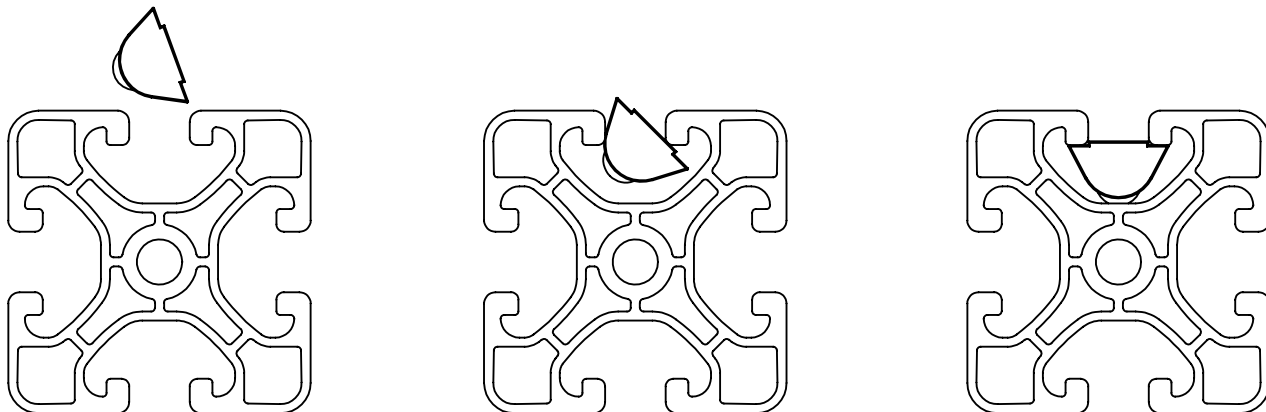

INCLUDED ITEMS

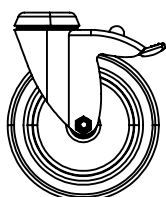

Caster Wheel
4x

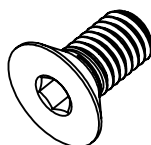

M8x16
4x



M8 T-Nut
4x



Caster Wheel

4x

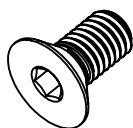

M8x16

4x



M8 T-Nut

4x

1

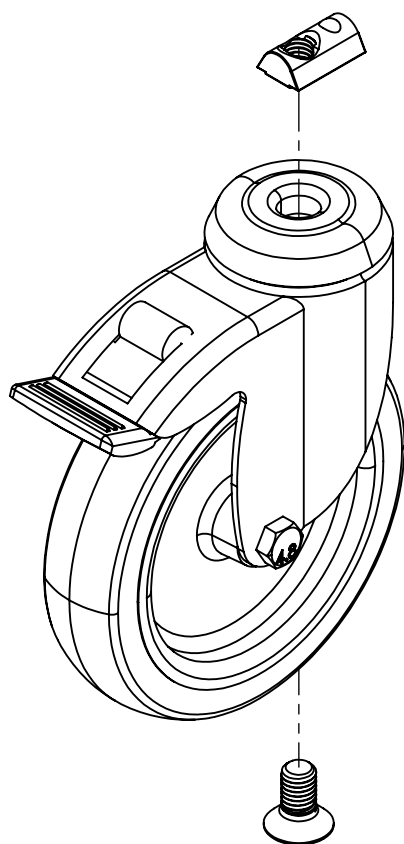
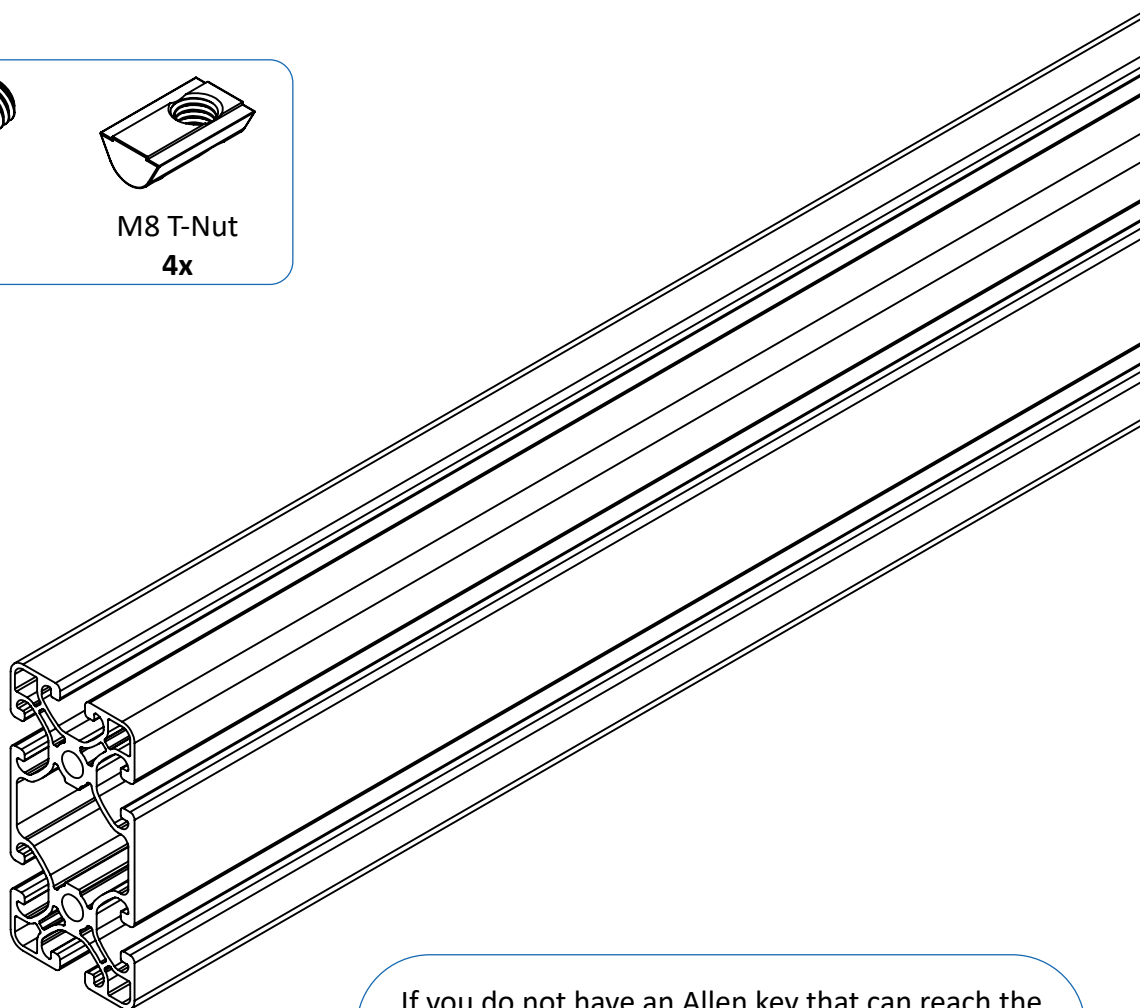

If you do not have an Allen key that can reach the M8x16 because the wheel is in the way, it might be easier to remove the wheel first.

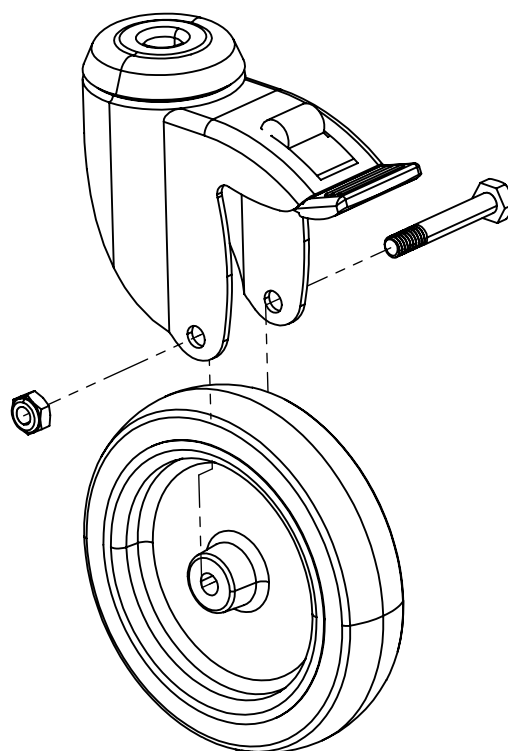

You can do this by using 2 wrenches of size 10 mm to loosen the bolt and nut holding the wheel. Once the body is attached to the aluminium profile, you can mount the wheel back on again.