

FORMULA

SIDE MOUNT

INSTRUCTION MANUAL

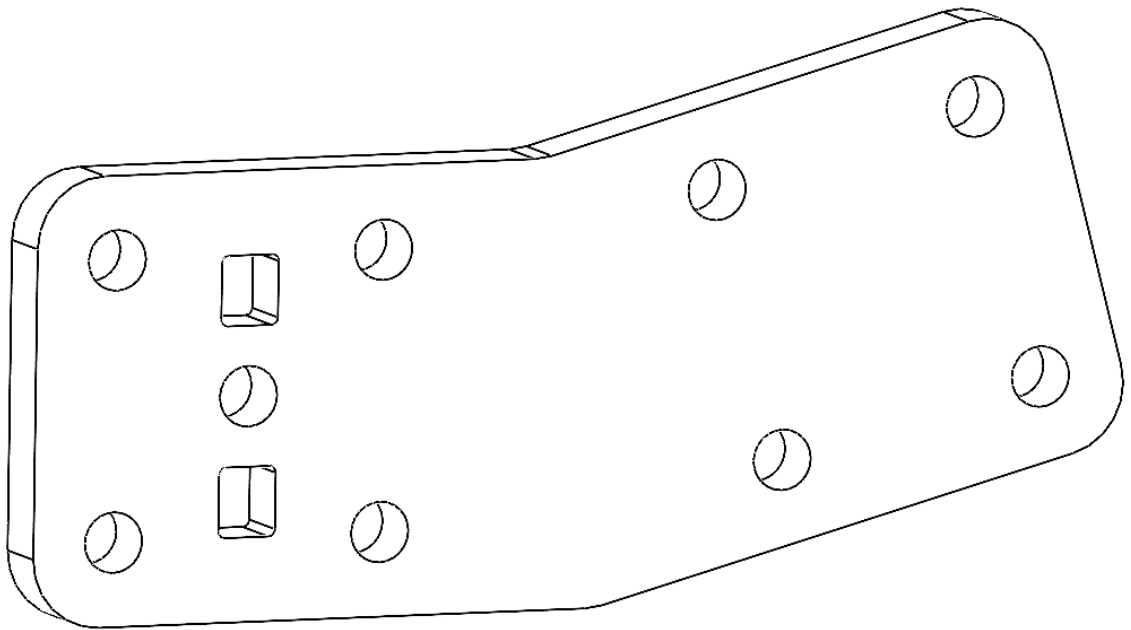

REQUIRED TOOLS:

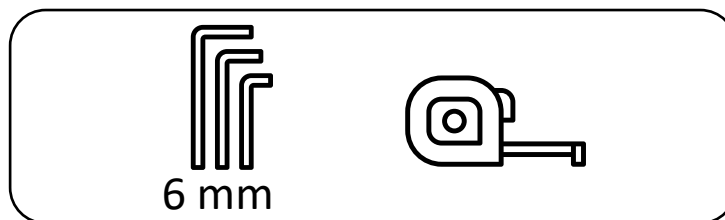

1

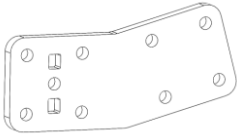

Side Mount

1x

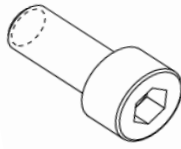

M8x20

8x

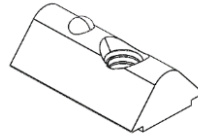

Click-in-Nut M8

8x

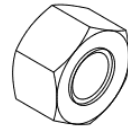

Nut M8

1x

2

Mount the plate to the skewed profile of the Formula Rig.
The 3 'extra' holes are there for securing the optional Keyboard Tray.

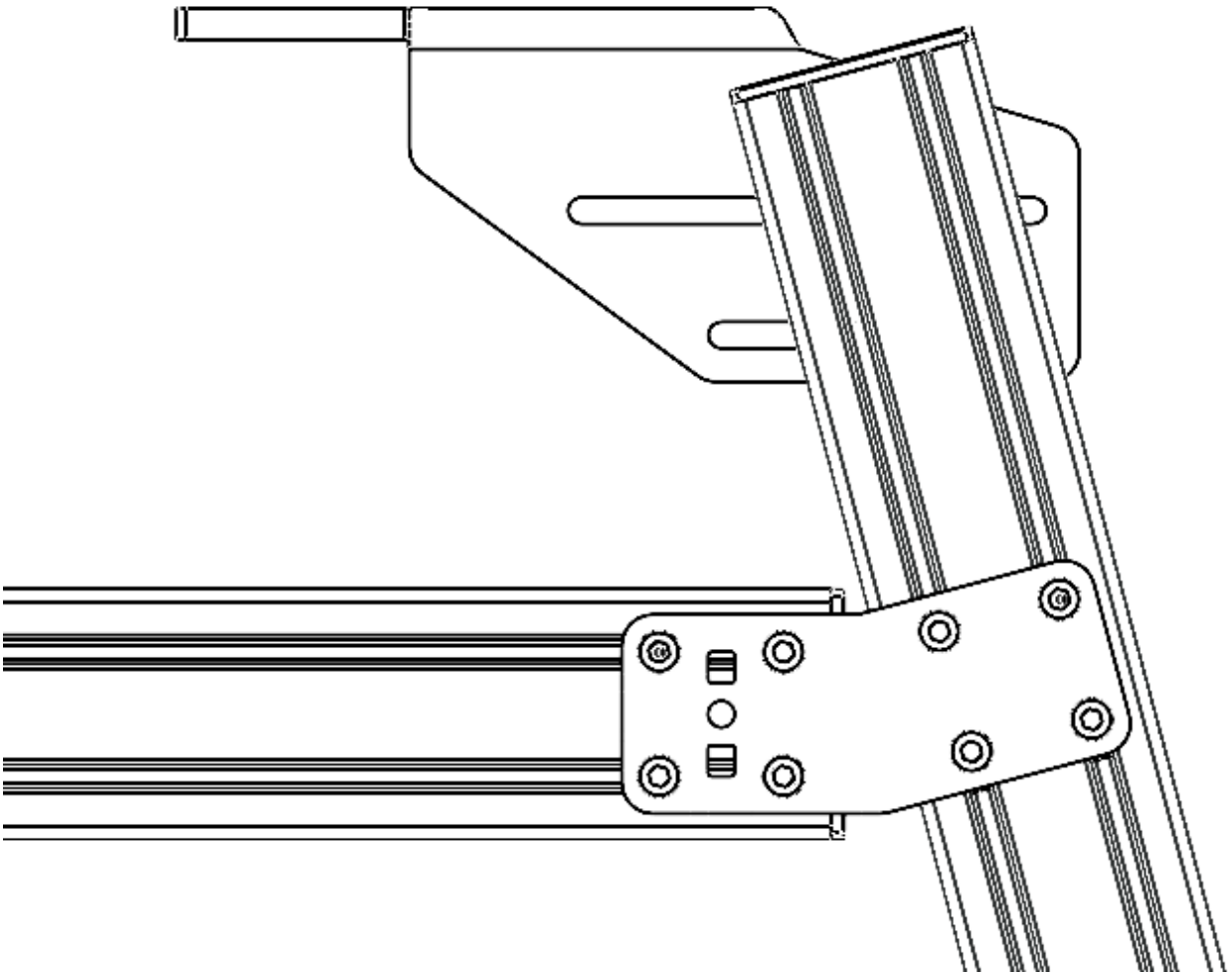

TREQ