

HEEL REST

INSTRUCTION MANUAL

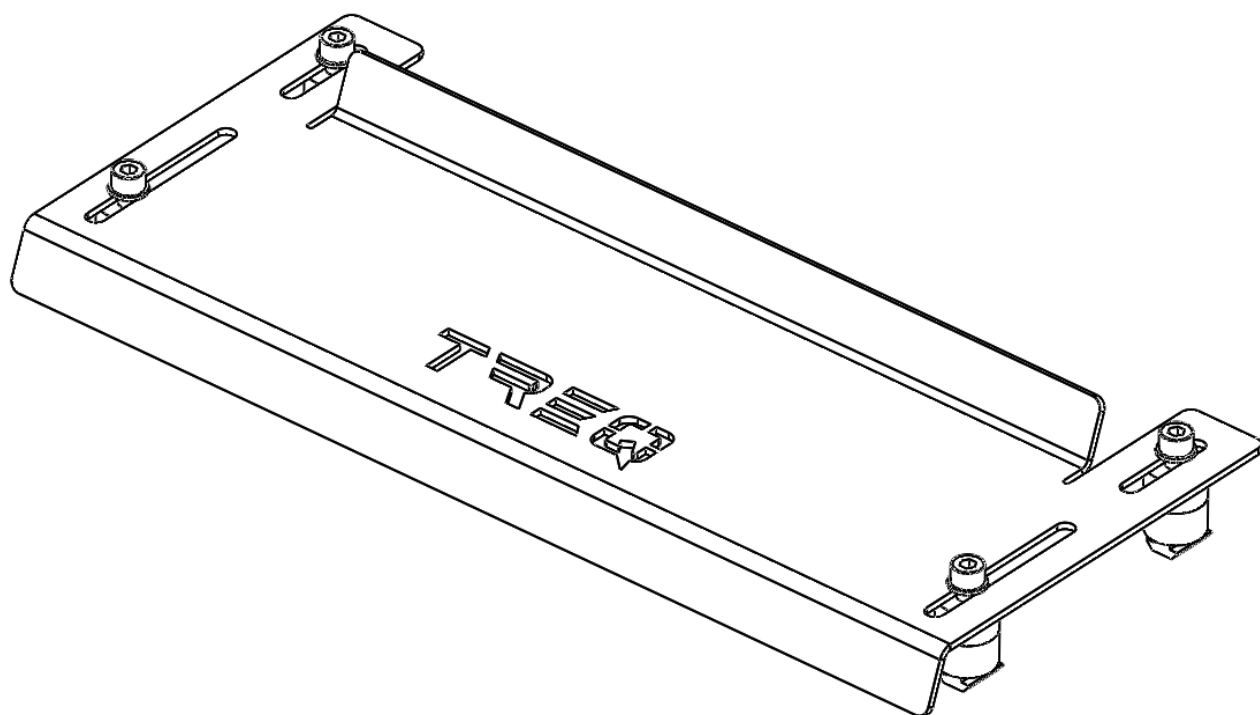

REQUIRED TOOLS:

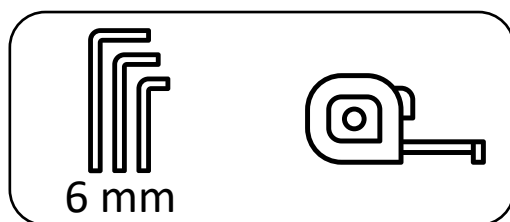

TREK

1

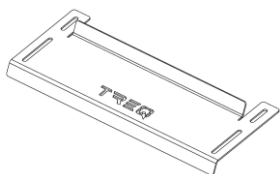

Plate

1x

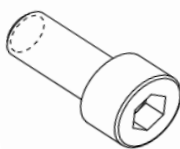

M8x16 (Black)

4x

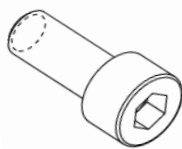

M8x30 (Black)

4x

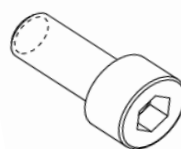

M8x45 (Black)

4x

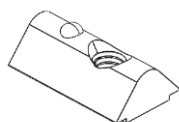

Click-in Nut M8

4x



Washer M8

4x



Spacer 15mm

8x

2

Mount your Heel Rest like show in the drawing. All spacers are optional.

- 0mm height: Use **M8x16** and 0 spacers
- 15mm height: Use **M8x30** and 1 spacer on each corner.
- 30mm height: Use **M8x45** and 2 spacers on each corner.

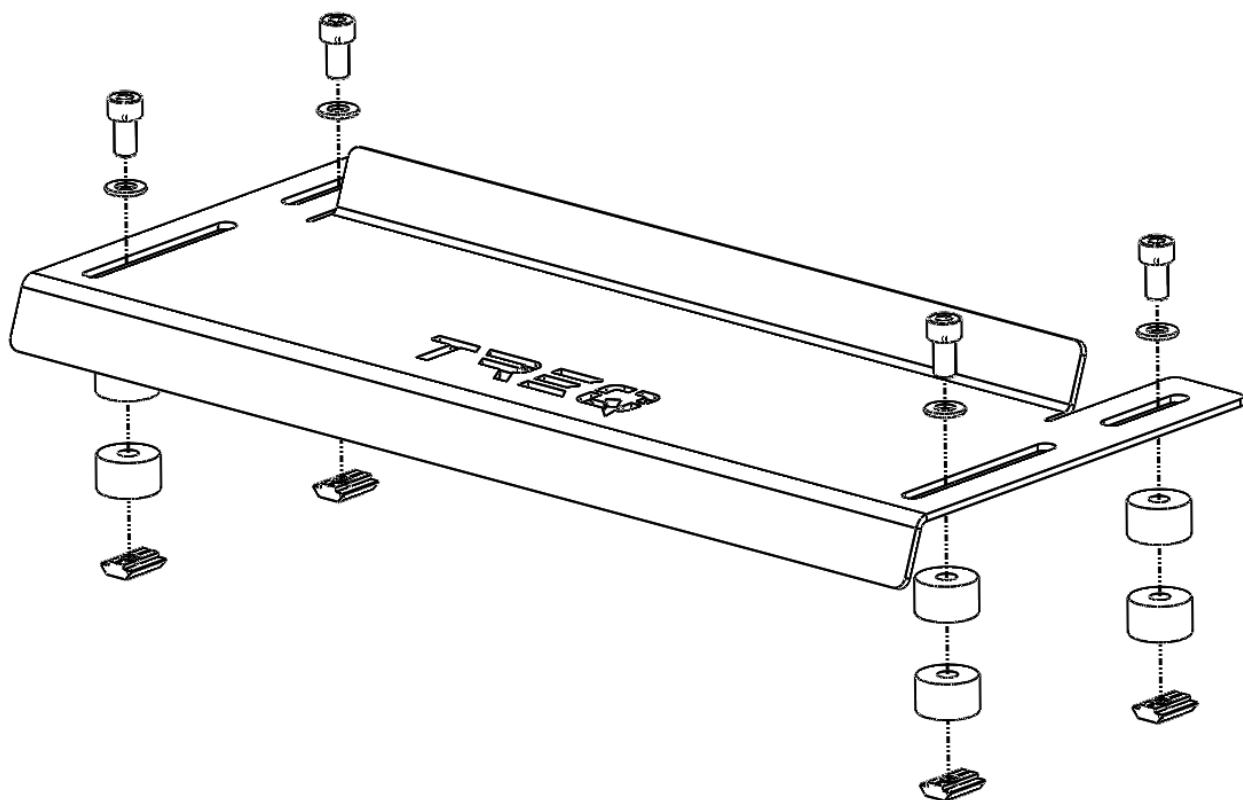

TREQ